

TEMPORARY FOOTPATH TO BE CONSTRUCTED / USED BY PEDESTRIANS OPPOSITE SIDE TO WORK AREA

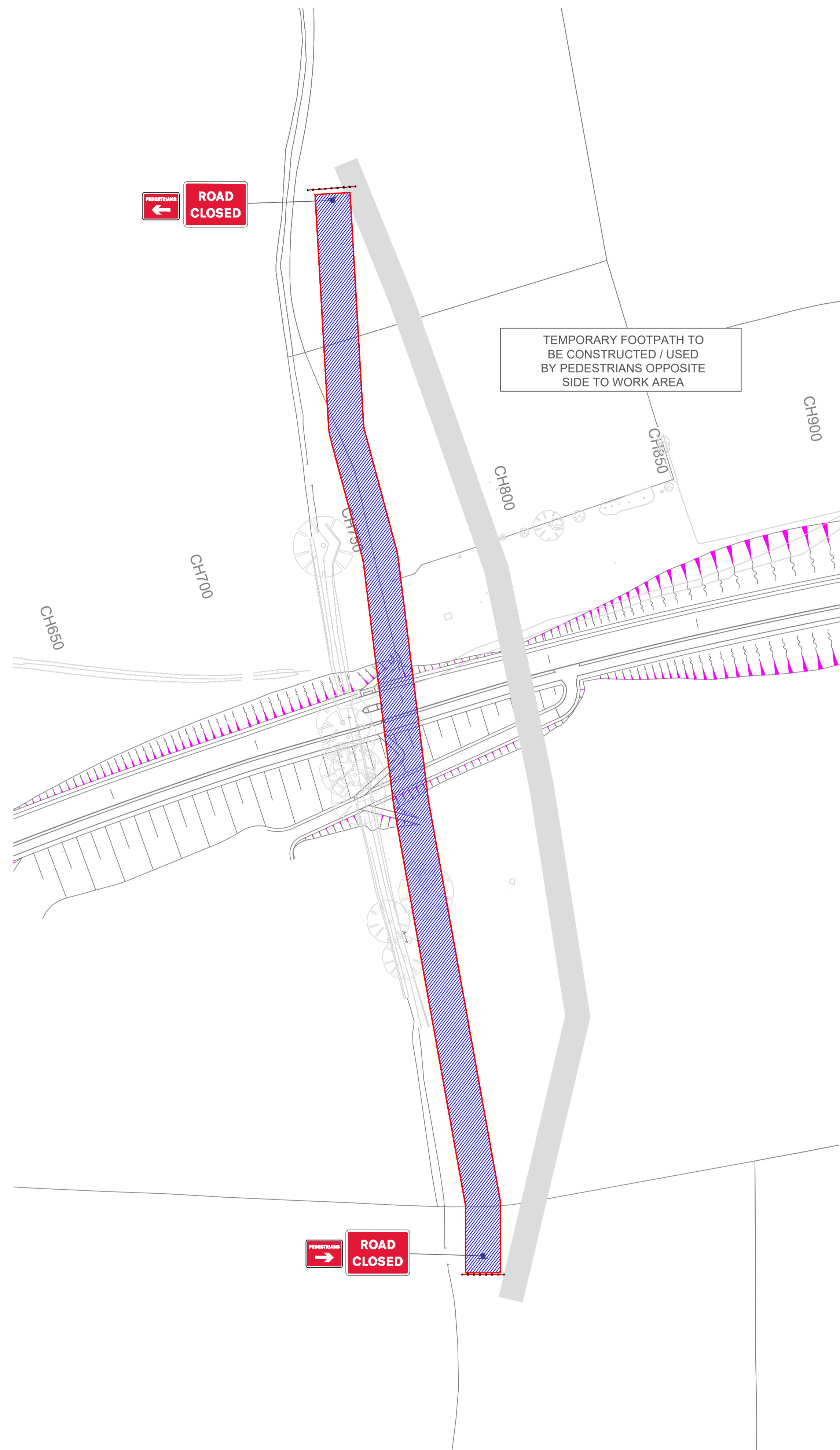

TEMPORARY FOOTPATH TO BE CONSTRUCTED / USED BY PEDESTRIANS OPPOSITE SIDE TO WORK AREA

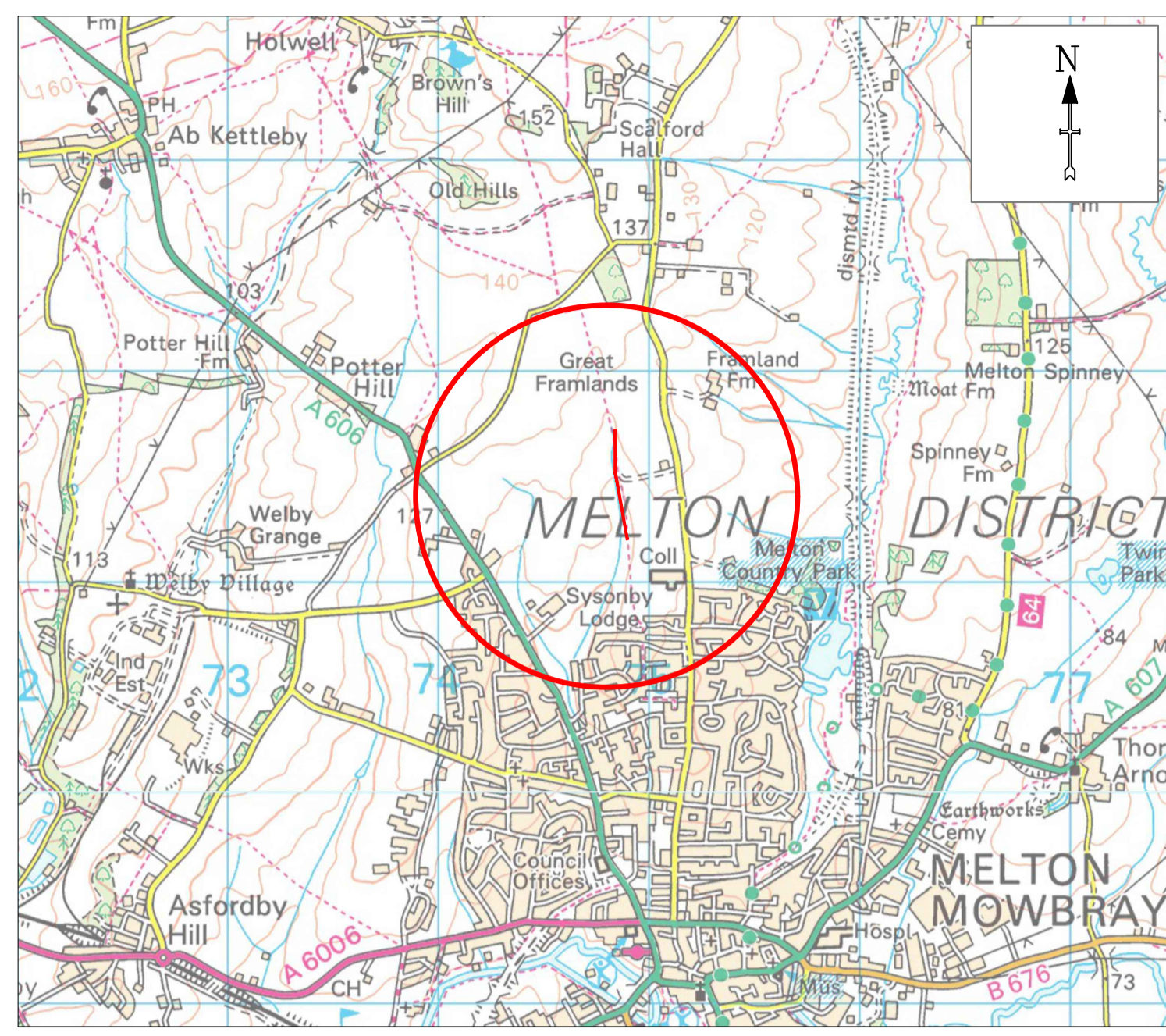

**MARTIN**  
 HW Martin Traffic Management  
 Fordbridge Lane  
 Blackwell  
 Derbyshire  
 DE55 5JY  
 Tel: 01773 813213  
 Email: traffic@hwmartin.com  
 www.hwmartin.com

Client:  
 Leicestershire County Council

Contractor:  
 GallifordTry

Project Title:  
**Melton Mowbray MMDR**

Drawing Title:  
**CLOSURE OF FOOTPATH E17**

Rev No	Details	Date

Drawn by: R.Searston	Date: 14/02/2023
Checked by: D.King	Date: 14/02/2023
Approved by: Client/Contractor	Date: TBC
©2018 HW Martin (Traffic Management) Ltd. <small>This drawing may not be copied, modified or used for any other purpose other than that for which it is intended without the written permission of HW Martin (Traffic Management) Ltd.</small>	

Drawing No: <b>HWM(TM)-C2544/Footpath/005</b>
Status: <input checked="" type="checkbox"/> For Comment <input type="checkbox"/> For Issue <input type="checkbox"/> As Built
Sheet No: 1 of 1 Original size: A3
HE Pin: Scale: NTS