

THE LEICESTERSHIRE COUNTY COUNCIL
(STATION ROAD AND KILWORTH ROAD, NORTH KILWORTH, DISTRICT OF
HARBOROUGH) (IMPOSITION OF 40MPH SPEED LIMIT) ORDER 202

THE LEICESTERSHIRE COUNTY COUNCIL hereby gives notice that it proposes to make an Order under Sections 5, 84 and part IV of Schedule 9 of the Road Traffic Regulation Act 1984 ("the Act"), and of all other enabling powers, and after consultation with the Chief Officer of Police in accordance with Part III of Schedule 9 to the Act, the effect of which will be:

1. To impose a 40mph Speed Limit on parts of A4304 Station Road and A4304 Kilworth Road, North Kilworth

A copy of the proposed Order together with a plan illustrating the proposals may be inspected during normal office hours at my offices, Room 200, County Hall, Glenfield, Leicester LE3 8RA and at the offices of Harborough District Council, The Symington Building, Adam and Eve Street, Market Harborough LE16 7AG and on the notice board of North Kilworth Parish Council.

Documents can also be viewed online at <https://www.leicestershire.gov.uk/roads-and-travel/cars-and-parking/traffic-management-consultations>

Objections to the proposals, specifying the grounds on which they are made, should be sent in writing to the undersigned by not later than 4th July 2024 quoting reference JM/HTWMT/5753. Alternatively, objections can be emailed to jane.x.moore@leics.gov.uk or via the online comment form which may be accessed via the link above. If you require alternative formats of this Notice, including larger print or braille, please contact Leicestershire County Council on (0116) 305 0001.

Dated: 13th June 2024

LAUREN HASLAM, Director of Law & Governance, Leicestershire County Council, County Hall, Glenfield, LE3 8RA

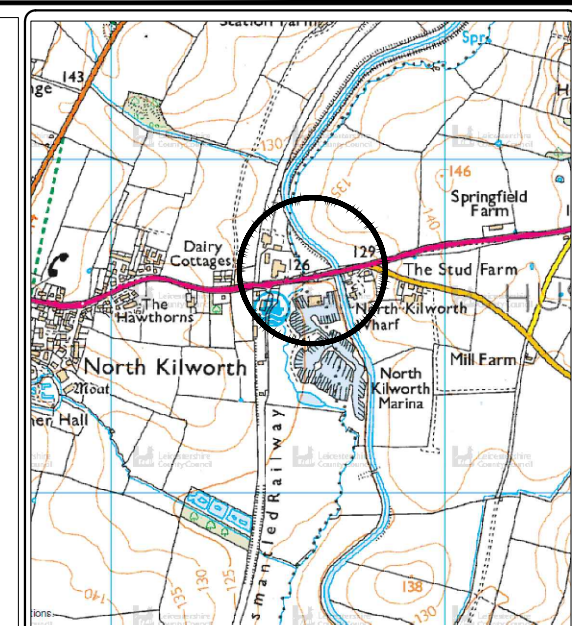
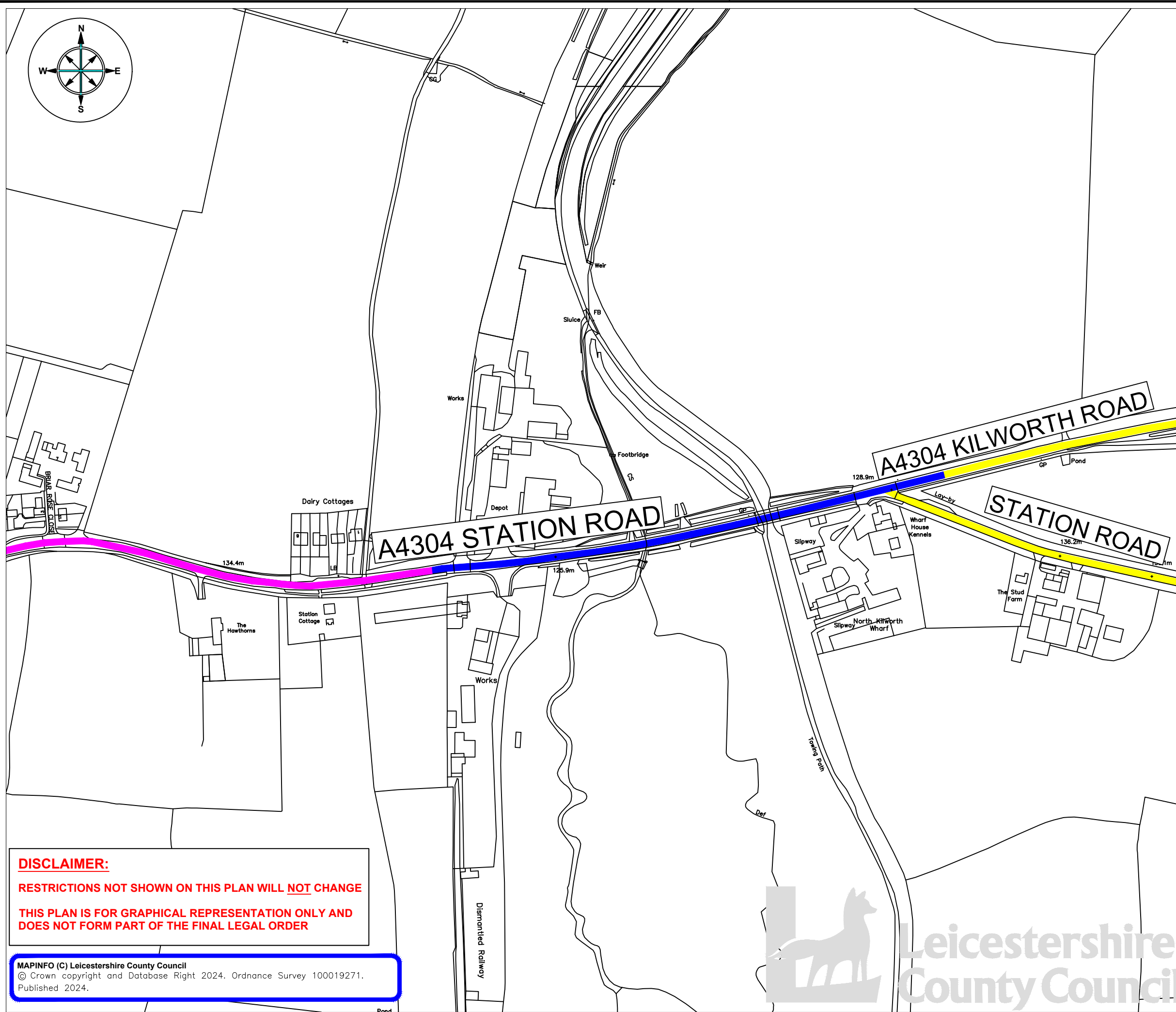
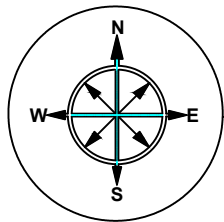

KEY

- EXISTING 30MPH SPEED LIMIT
- EXISTING NATIONAL SPEED LIMIT
- PROPOSED 40MPH SPEED LIMIT



**ENVIRONMENT AND
TRANSPORT DEPARTMENT**

**ANN CARRUTHERS
DIRECTOR**

**NETWORK MANAGEMENT
DEVELOPMENT & GROWTH**

**A4304 STATION ROAD & A4304 KILWORTH ROAD
NORTH KILWORTH & HUSBANDS BOSWORTH**

TITLE:

**PROPOSED 40MPH SPEED LIMIT
CONSULTATION PLAN**

DRAWING NUMBER		SCALE	
TMD.055/T1/1		NTS	
PREPARED BY:	P SANDHU	DATE:	MAY 2024
CHECKED BY:	L MEASURES	SIZE :	A3
APPROVED BY:	G NEAT	CORR. FILE :	

COUNTY HALL * GLENFIELD * LEICESTER * LE3 8ST
Tel: 01163 050001 * Fax: 0116 3050006

E.Mail address: customerservices@leics.gov.uk
Website: www.leicestershire.gov.uk

DISCLAIMER:
RESTRICTIONS NOT SHOWN ON THIS PLAN WILL NOT CHANGE
**THIS PLAN IS FOR GRAPHICAL REPRESENTATION ONLY AND
 DOES NOT FORM PART OF THE FINAL LEGAL ORDER**

MAPINFO (C) Leicestershire County Council
 © Crown copyright and Database Right 2024. Ordnance Survey 100019271.
 Published 2024.



LEICESTERSHIRE COUNTY COUNCIL

A4304 STATION ROAD & A4304 KILWORTH ROAD

PARISH OF NORTH KILWORTH AND HUSBANDS BOSWORTH

DISTRICT OF HARBOROUGH

PROPOSED 40MPH SPEED LIMIT

STATEMENT OF REASONS

Leicestershire County Council proposes to make the following order.

On behalf of the developer, Mather Jamie Ltd it is necessary to reduce part of the existing national speed limit (60mph) and introduce a 40mph speed limit on the A4304 Station Road and Kilworth Road.

The proposed 40mph speed limit is intended to improve safety for access and egress at the new Marina development and provide a safe highway environment.

This order will see a 40mph speed limit on the following roads:

A4304 Station Road and A4304 Kilworth Road.

This scheme is being introduced on the grounds of road safety.

The proposals are shown in plan TMD.055/T1/1.

THE LEICESTERSHIRE COUNTY COUNCIL
(STATION ROAD AND KILWORTH ROAD, NORTH KILWORTH, DISTRICT OF
HARBOROUGH) (IMPOSITION OF 40MPH SPEED LIMIT) ORDER 202

The Leicestershire County Council ("the Council") in exercise of its powers under Sections 5 , 84 and Part IV of Schedule 9 of the Road Traffic Regulation Act 1984 ("the Act") and of all other enabling powers and after consultation with the chief officer of police in accordance with Part III of Schedule 9 to the Act and Regulation 23 of the Local Authorities Traffic Order (Procedure) England and Wales Regulations 1996, hereby makes the following Order:-

1. This Order may be cited as "The Leicestershire County Council (Station Road and Kilworth Road, North Kilworth, District of Harborough) (Imposition of 40mph Speed Limit) Order 202"
2. The Order shall come into force on the day of 202
3. No person shall drive any motor vehicle at a speed exceeding 40 MPH on the lengths of roads as specified in the Schedule to this Order.
4. The plan annexed to this Order and marked drawing number TMD.055 /T1/1 is for identification purposes only.

SCHEDULE

IMPOSITION OF 40 MPH SPEED LIMIT

A4304 Station Road, in the Parish of North Kilworth

From a point 300 metres east of its junction with Briar Roase Close, North Kilworht to its junction with Station Road, Husbands Bosworth

A4304 Kilworth Road, in the Parish of Husbands Bosworth

From its junction with Station Road, Husbands Bosworth to a point 50 metres northeast of its junction with Station Road, Husbands Bosworth.

THE COMMON SEAL of THE LEICESTERSHIRE)
COUNTY COUNCIL was hereunto affixed)
This day of 202)
in the presence of :-)