

All Statutory Undertakers
with apparatus in Leicestershire

Date: 22th July 2025
My Ref: 519051A
Contact: Thomas Harris
Phone: 0116 305 0001
Online: <https://www.leicestershire.gov.uk/contact-information>

LEICESTERSHIRE COUNTY COUNCIL

NEW ROADS AND STREET WORKS ACT 1991

DEPARTMENT OF ENVIRONMENT & TRANSPORT

NOTICE TO UNDERTAKERS – SECTION 58

THIS IS A NOTICE, NOT A SEARCH

The LEICESTERSHIRE COUNTY COUNCIL by its Director of Environment and Transport, acting in virtue of the powers vested in the Council as Highway Authority, hereby gives 3 months advance notice under Section 58 of the Act of its intention to execute substantial road works in accordance with the accompanying plan.

Subject to the exemptions in the Act and Regulations under it, no street works may be executed for a period of 36 months from the completion of the works described without the consent of the said Leicestershire County Council. Should such street works be planned you are requested to contact the above-named officer to discuss how the works can best be co-ordinated.

1. Scheme Title: North Street, Melton Mowbray
2. Description of works: Carriageway Resurfacing
3. Highway and route number: North Street, Melton Mowbray
4. USRN(s): 24900543
5. Grid Reference:
6. Terminal points of site: 475324 319436
(Refer to enclosed plan for 475219 319500
location and extents of works)
7. Programmed start date: 06/10/2025
8. Programmed completion date: 15/10/2025
9. Address for reference: 5, The Old Dairy, North St, Melton Mowbray LE13 1NL

Yours faithfully,

Environment and Transport Department
Leicestershire County Council, County Hall, Glenfield. Leicestershire LE3 8RJ
Telephone: 0116 305 0001
Online: <https://www.leicestershire.gov.uk/contact-information>

Director, Ann Carruthers

www.leicestershire.gov.uk

Thomas Harris
Engineer

Environment and Transport Department
Leicestershire County Council, County Hall, Glenfield. Leicestershire LE3 8RJ
Telephone: 0116 305 0001
Online: <https://www.leicestershire.gov.uk/contact-information>

Director, Ann Carruthers

www.leicestershire.gov.uk

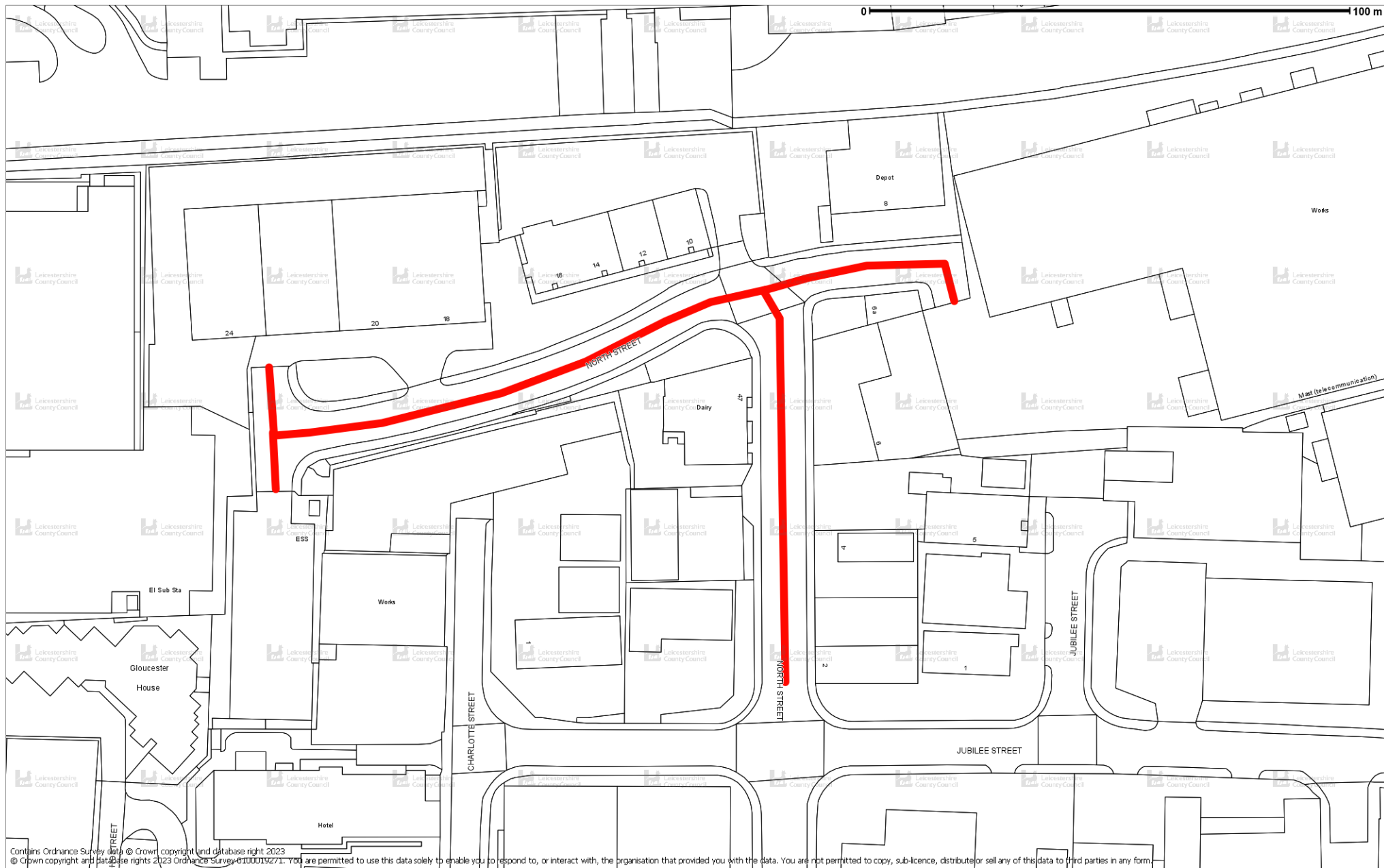

© Crown copyright and database rights 2023 Ordnance Survey 0100019271. You are permitted to use this data solely to enable you to respond to, or interact with, the organisation that provided you with the data. You are not permitted to copy, sub-licence, distribute or sell any of this data to third parties in any form.

Scale 1:1075



North Street, Melton Mowray

Location Plan

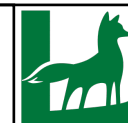

Leicestershire
County Council