

THE LEICESTERSHIRE COUNTY COUNCIL
(PARK STREET AND RECTORY LANE, MARKET BOSWORTH)
(BOROUGH OF HINCKLEY & BOSWORTH)
(REVOCATION) ORDER 2025

The Leicestershire County Council ("the Council") in exercise of its powers under Sections 1(1), 2(1), 2(2) and 124 of the Road Traffic Regulation Act 1984 ("the Act") and of all other enabling powers, after consultation with the Chief Officer of Police in accordance with Part III and Part IV of Schedule 9 to the Act, hereby makes the following Order: -

1. This Order may be cited as "The Leicestershire County Council (Park Street and Rectory Lane Market Bosworth) (Borough of Hinckley & Bosworth) (Revocation) Order 2025"
2. The Order shall come into force on the sixth day of October 2025
3. The Order referred to in the Schedule is hereby revoked in full
4. The plan annexed to this Order and marked drawing number P302802/T5/1 is for identification purposes only

SCHEDULE

REVOCATION IN FULL

THE COUNTY OF LEICESTER (PARK STREET AND RECTORY LANE, MARKET
BOSWORTH) (ONE WAY) ORDER, 1960.

THE COMMON SEAL of THE LEICESTERSHIRE)
COUNTY COUNCIL was hereunto affixed)
this twenty-fifth day of September 2025)
in the presence of :-)

Authorised Signatory

Peter Self



417954

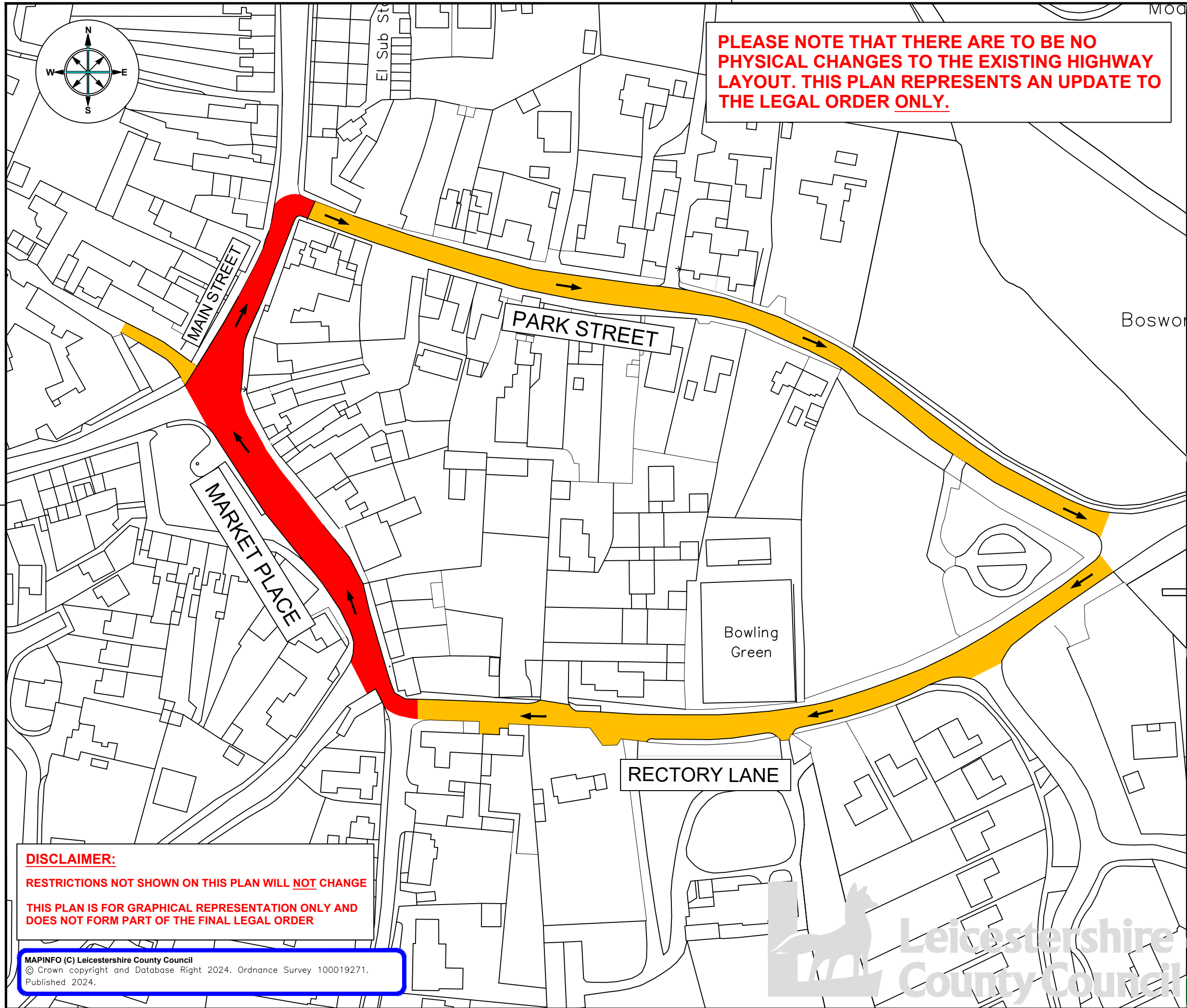

PLEASE NOTE THAT THERE ARE TO BE NO PHYSICAL CHANGES TO THE EXISTING HIGHWAY LAYOUT. THIS PLAN REPRESENTS AN UPDATE TO THE LEGAL ORDER ONLY.

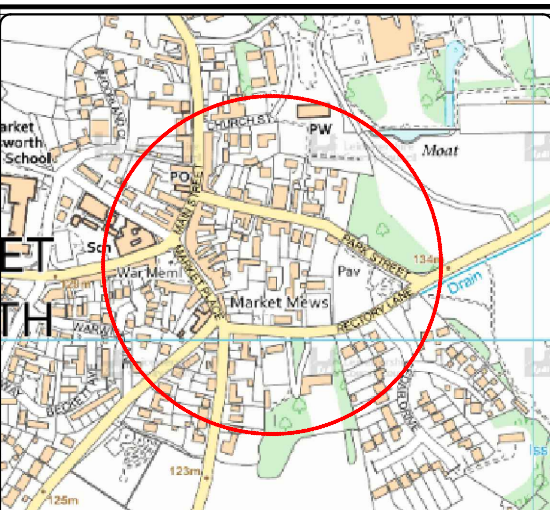

- ONE WAY SYSTEM TO BE REVOKED & INTEGRATED INTO NEW ORDER
- NEW ONE WAY SYSTEM TO BE INTEGRATED INTO ONE GYRATORY SYSTEM



ENVIRONMENT AND
TRANSPORT DEPARTMENT

ANN CARRUTHERS
DIRECTOR

NETWORK MANAGEMENT
DEVELOPMENT & GROWTH

MARKET BOSWORTH

TITLE:
**ONE WAY SYSTEM
REVOCATION ORDER**

DRAWING NUMBER	SCALE
P302802/T5/1	NTS
PREPARED BY: W ARNOLD	DATE: JUNE 2025
CHECKED BY: A HUGHES	SIZE : A3
APPROVED BY: A HUGHES	CORR. FILE :

COUNTY HALL * GLENFIELD * LEICESTER * LE3 8ST
Tel: 01163 050001

www.leicestershire.gov.uk

DISCLAIMER:
RESTRICTIONS NOT SHOWN ON THIS PLAN WILL NOT CHANGE
THIS PLAN IS FOR GRAPHICAL REPRESENTATION ONLY AND
DOES NOT FORM PART OF THE FINAL LEGAL ORDER

MAPINFO (C) Leicestershire County Council
© Crown copyright and Database Right 2024. Ordnance Survey 100019271.
Published 2024.

