

LEICESTERSHIRE & RUTLAND MINERALS LOCAL PLAN – FUTURE SAND & GRAVEL PROPOSALS

SITE : CADEBY QUARRY – Newbold Road Extension

Resource and Operational Details

- Total Reserve (tonnes). 1.5 million tonnes
- Estimated Annual Output. 150,000 – 180,000 tonnes pa
- Geological evidence to indicate that a suitable quality and quantity of material is available.

Sand and gravel resource proved from borehole drilling. See plan 2382/ BH/1.

Sand and gravel ranging from 3.6m – 11.25m (average 4.75m) thickness. Soils and clay overburden ranging from 0.3 – 3.0m (average 1.4m) thickness.

Resource similar to that currently worked at existing quarry and worked historically on land immediately to the west of Newbold Road.

- Timescale for proposed extraction (approximate start date; estimated life of workings).

Likely to be required to provide continuity for Cadeby Quarry within next 5 years.

The resource would provide circa 8 -10 years of production continuity for Cadeby Quarry.

- Phasing of proposed workings.

Subject to further design, although general progression from south to north likely to be most appropriate programme linked with progressive restoration. Early screening on northern boundary towards Kirkby Old Parks, with combination of earthworks and tree planting will be key feature of working and restoration design.

Concept working and restoration design shown on plans 2382/SK/1 - 5

Environmental Information

- Does the site affect Agricultural Grades 1, 2 or 3a 'best and most versatile' land?

Soil resource survey not yet conducted, but likely to similar to soils at existing Cadeby Quarry, which are combination of grade 3b, 3a and 2.

Land can be restored to agriculture at lower level using on site materials.

- Has any impact on Ecology been assessed?

No detailed site survey undertaken yet. Land is predominantly arable. Hedgerow and protected species surveys to be carried out.

- Has any impact on Groundwater/Hydrology been assessed?

Hydrogeology assessment to be conducted, but issues likely to be similar to the existing quarry with scope for appropriate monitoring and mitigation strategy.

- Will the site affect any international, national, regional or local designated sites?

Not as far as aware.

- Will the site affect any known archaeological features and/or historical buildings, structures or gardens?

Initial desk top assessment identifies two records (MLE 3043 – Medieval / post medieval earthworks at Kirkby Moats and MLE 3047 – Iron Age pit alignment).

Transportation

- Means and route of transportation of material to any processing plant and out of the site.

Mineral transported by conveyor via culvert under Newbold Road to access the former Cadeby Quarry working area west of Newbold Road. The conveyor will then link to processing plant via the existing conveyor corridor

Mineral to be processed through existing processing plant and existing road access onto Brascote Lane leading to the A447 will continue to be used.

Restoration

- Proposed use at the cessation of workings.

Restoration likely to be predominantly to agriculture at lower level, using on site overburden and soils. Opportunity for new hedgerows and some woodland planting, with water bodies/ ponds in base of re-profiled landform.

- Will the restoration require importation of waste?

No requirement for imported materials.

Restoration to be achieved using on site overburden and soils only.

Buffer zones

- Are there any sensitive uses adjoining or adjacent to the proposed site (i.e. housing, schools, health, community uses)? If Yes, what distance are these uses from the proposed site?

Land is generally remote from residential property to the east. Appropriate operational stand-off can be designed for properties on the western and southern fringes. Beech Spinney provides good established mature tree screen to properties west of Newbold Road.

- What other measures will be implemented to act as a buffer zone to reduce impacts.

Landscape screening through earthworks and tree planting can be designed to provide additional visual and acoustic screening.

Existing agricultural track from Beech Spinney to Bullacre Spinney forms natural boundary for extraction operations, although earthworks screening proposed on land immediately north of the track.

Other information

- Have you undertaken any surveys or environmental impact assessments of the site? (Please provide copies where possible).

Assessments being undertaken to assist with preparation of formal Scoping Report.

- Are there any reasons why any of the land that you have identified may not be available for sand and gravel extraction during the proposed plan period (i.e. before 2031)? Please explain briefly the reasons why.

Proposal will be subject to formal Scoping and Environmental Impact Assessment.

Scheme of working and restoration to be agreed with the land owner and other parties with legal interest in relation to the working of sand and gravel (covenants relating to sale of land by RMC Ltd in 1979).

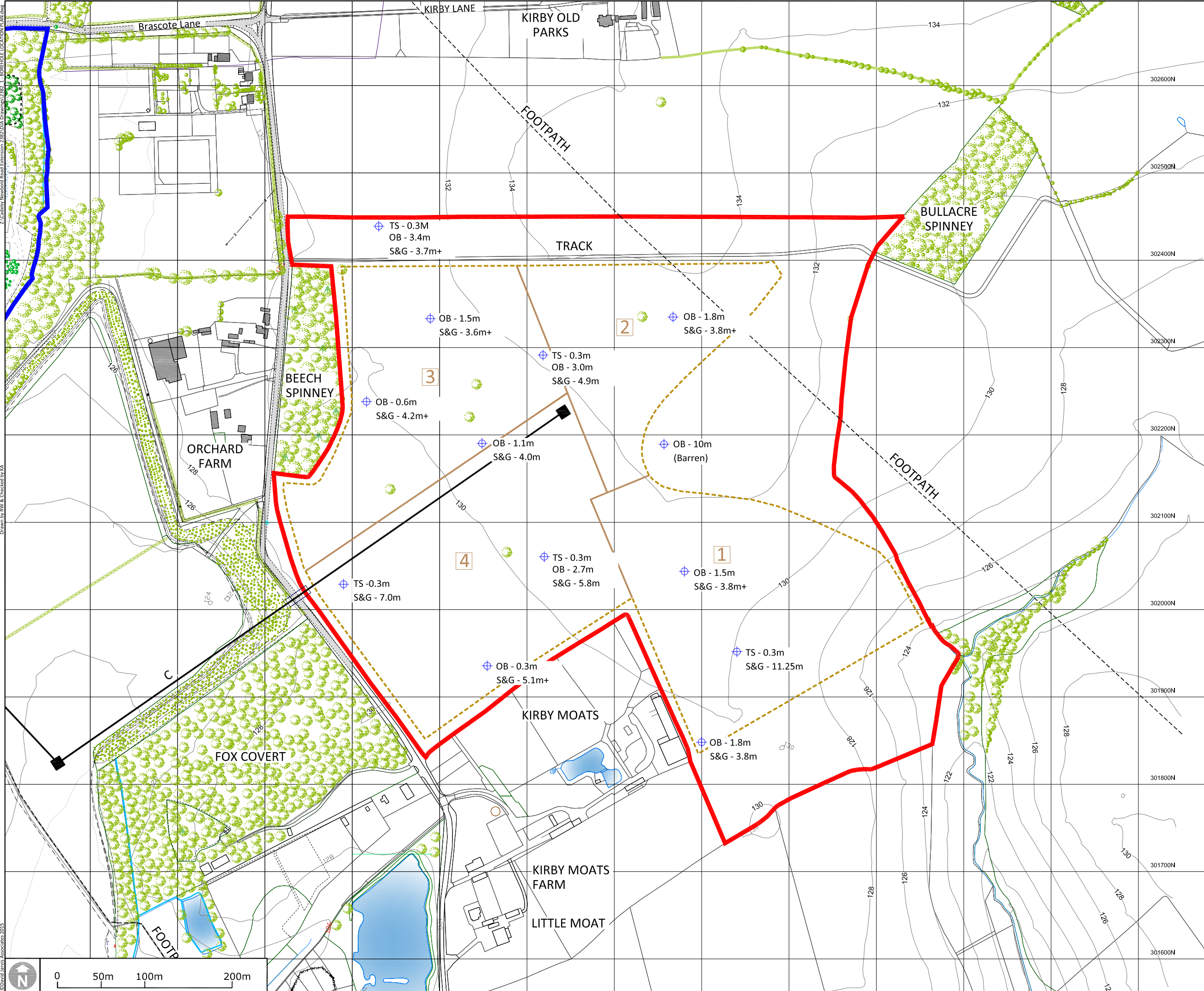

- KEY
- BOUNDARY: POTENTIAL EXTENSION SITE
 - BOUNDARY: OTHER LAND IN THE CONTROL OF THE APPLICANT
 - BOUNDARY: PROPOSED MINERAL EXTRACTION
 - EXISTING CONTOURS
 - EXISTING PUBLIC RIGHTS OF WAY
 - HV TRANSMISSION LINE
 - EXISTING TREES & HEDGES
 - EXISTING RECENT TREE PLANTING
 - PROPOSED QUARRY PHASING
 - PROPOSED MINERAL CONVEYOR
 - BOREHOLE LOCATION

Notes

- Borehole Locations based on approximate positions provided in Kirkby Old Park Farm Survey Report ref: R.S.1520/1, dated March 1971.

Drawing Revision		
Rev	Date	Description

Drawing Status

ISSUED FOR INFORMATION

DAVID JARVIS ASSOCIATES

DAVID JARVIS ASSOCIATES LIMITED
1 Tennyson Street Swindon Wiltshire SN1 5DT
Tel: 01793 612173 Fax: 01793 613625
Email: mail@davidjarvis.biz

Client

CADEBY QUARRY

Project

NEWBOLD ROAD EXTENSION

Drawing Title

BOREHOLE LOCATION PLAN

Scale	Sheet Size	Date
1:4000	A3	JULY 2015
Drawing No.	Revision	
2382/BH/1	-	

©David Jarvis Associates 2015
This map is based upon Ordnance Survey Material with the permission of Ordnance Survey on behalf of the controller of Her Majesty's Stationary Office ©Crown copyright. Unauthorised reproduction infringes Crown copyright and may lead to prosecution or civil proceedings. Reproduced with the permission of the controller of HMSO, Licence No: AR 189685.
Z:\Cadbury Newbold Road Extension\2382 BH.dwg
1 - BOREHOLE LOCATION PLAN.dwg
Drawn by RW & Checked by KA