

Definitive Map of Rights of Way for Leicestershire Register of Definitive Map Modification Order Applications

Short Description: Alleged footpath down concrete steps from Leicester Road, on Leicester Road Canal Bridge, through old pub garden of the derelict County Arms, to the Grand Union Canal towpath.			
Application No.:	M579	Legal Services Ref. No.:	COMHS/XXX
Application Status:	Under consideration		
Geographical Location			
Path No:	Z112	Route name (if known):	County Arms Path
Settlement:	Glen Parva		
Parish:	Glen Parva		
District/Borough:	Blaby		
Nearest Town/City:	Leicester		
Nearest Postcode:			
Start Grid Refs:	Landranger:	SP 537 979	Eastings,Northings: 453750,297950
End Location:			
End Grid Refs:	Landranger:	SP 542 983	Eastings,Northings: 454250,298350
Applicant's Name, Address & Postcode: Mrs. J. Small, Clerk to Glen Parva Parish Council, Parish Council Office, Dorothy Avenue, Glen Parva, Leicester, LE2 9JD.			
Date Received:	13/01/2003	Date Determined:*	
Application Stage(s): <ul style="list-style-type: none"> • Application received • Currently being dealt with as a Deed of Dedication with site developers, together with a new footpath east of the site. (Z115 & Z116) 			
For Further Information			
Case Officer:	Piers Lindley		
Telephone:	0116 305 7087	Fax:	0116 305 7014
Email:	footpaths@leics.gov.uk		
Contents List:			Page:
Application Form			2
Map accompanying the application			3
Additional Documents – Proposed Deed of Dedication Plan			4
Inspector's Decision			

* Note the **Determination Date** is the occasion on which Leicestershire County Council formally decided whether or not to make an order in response to this application.

APPLICATION FOR DEFINITIVE MAP MODIFICATION ORDER

WILDLIFE AND COUNTRYSIDE ACT 1981

DEFINITIVE MAP AND STATEMENT FOR THE COUNTY OF LEICESTERSHIRE

Please complete this form and return it together with Form PT636, and any evidence you wish to submit, to: Environmental Management Group, Department of Community Services, Leicestershire County Council, County Hall, Glenfield, Leicester, LE3 8RJ.

I/We GLEN PARVA PARISH COUNCIL

of Parish Council Office, Dorothy Avenue, Glen Parva, Leicester, LE2 9JD.

hereby apply for an Order under Section 53(2) of the Wildlife and Countryside Act 1981, modifying the Definitive Map and Statement for the area by

~~*adding a footpath/bridleway/byway open to all traffic~~

~~*deleting a footpath/bridleway/byway open to all traffic~~

~~*upgrading the footpath/bridleway~~

~~*downgrading the bridleway/byway open to all traffic~~

~~*varying the particulars in the Definitive Statement relating to the footpath/bridleway/byway open to all traffic~~

(*delete as appropriate)

which runs

from LEICESTER ROAD ACCESS STEPS AT COUNTY ARMS PUBLIC HOUSE

to GRAND UNION CANAL TOW PATH (Z13)

as shown on the attached plan.

I/We attach copies of the following documentary evidence (including statements of witnesses) in support of this application:

List of Documents

EVIDENCE FORMS TO FOLLOW

THE PARISH COUNCILS BELIEVES THAT THIS ROUTE HAS BEEN USED UNRESTRICTED FOR MORE THAN A PERIOD OF TWENTY YEARS, PRIOR TO THE INSTALLATION OF A NOTICE RESTRICTING ACCESS WHICH WAS PLACED ON ACCESS GATE ON 17/12/02 BY MANAGING AGENT OF PROPERTY

Signed [Redacted] Dated 13-1-03

J. Small

Leicestershire County Council - Public Path Creation Agreement - Public Footpaths Z115 and Z116 at the site of the old County Arms Public House, Glen Parva.

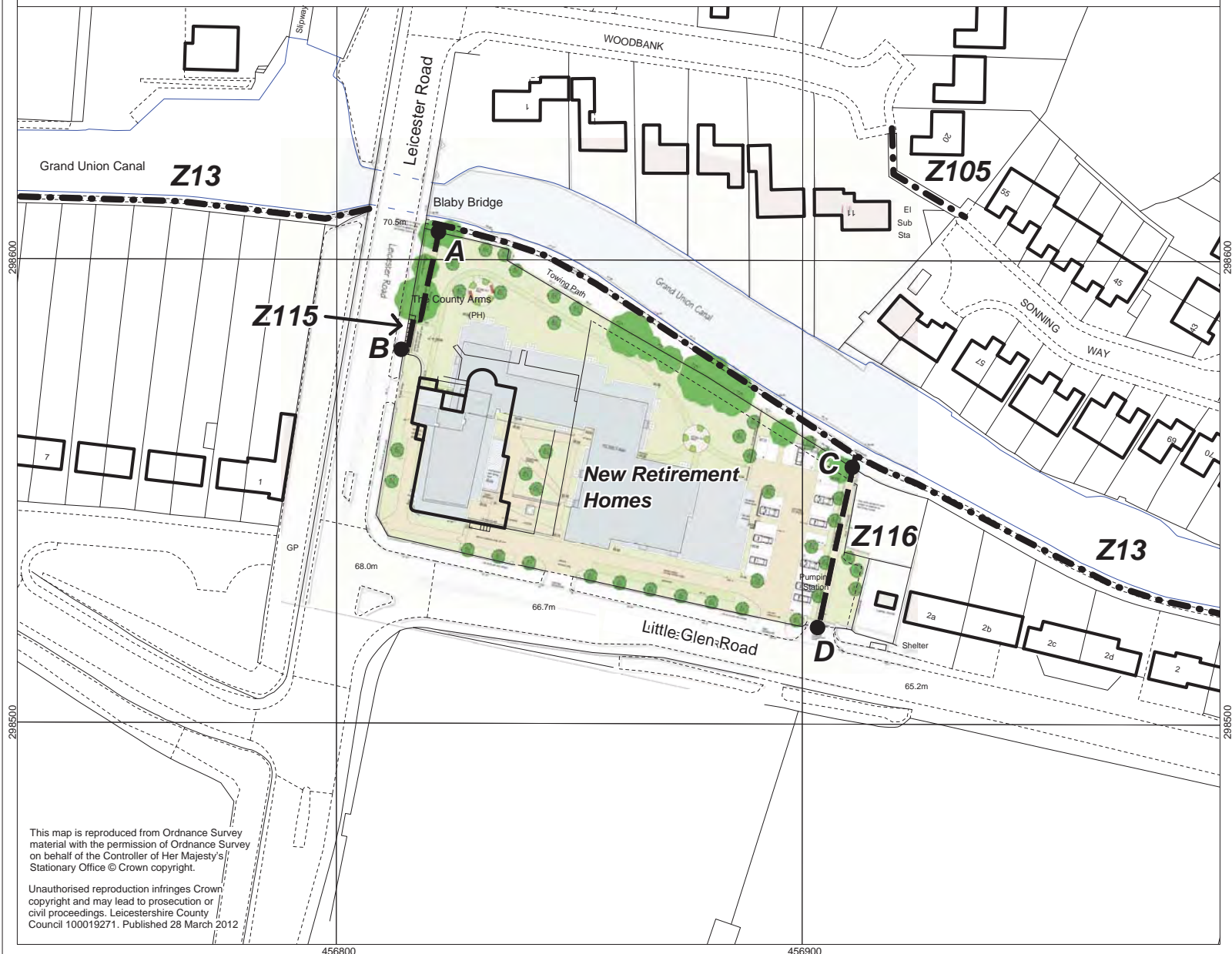

Location Plan

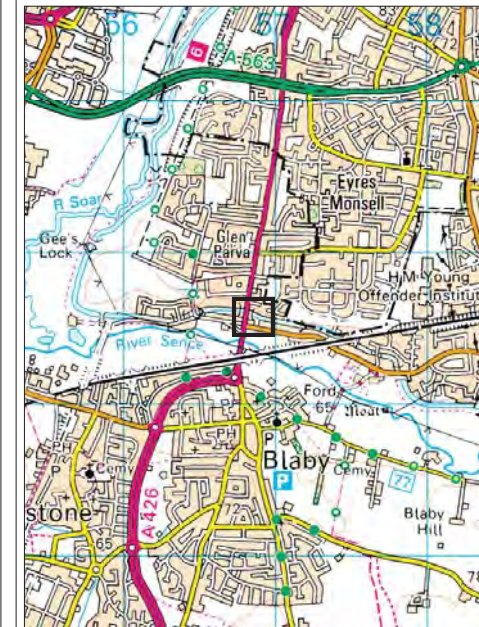

Key

- Footpaths to be created
- Existing public footpaths

Environment & Transport Department,
 County Hall, Glenfield,
 Leicestershire LE3 8RJ
 email footpaths@leics.gov.uk
 Matthew Lugg, Director
 B.Eng., C.Eng., MICE, MCIHT, DMS



Plan No.2288/Cr.

Scale 1:1250

This map is reproduced from Ordnance Survey material with the permission of Ordnance Survey on behalf of the Controller of Her Majesty's Stationary Office © Crown copyright.

Unauthorised reproduction infringes Crown copyright and may lead to prosecution or civil proceedings. Leicestershire County Council 100019271. Published 28 March 2012.