

**Definitive Map of Rights of Way for Leicestershire
Register of Definitive Map Modification Order Applications**

Short Description: Alleged public footpath from Higham Lane, Wykin to recorded Public Footpath U4			
Application No.:	M1110	Legal Services Ref. No.:	N/A
Application Status:	Received		

Geographical Location			
Path No:	U4	Route name (if known):	
Settlement:	Wykin		
Parish:	Hinckley un-parished Area		
District/Borough:	Hinckley & Bosworth Borough		
Nearest Town/City:	Hinckley		
Start Location:	Higham Lane, Wykin		
Start Grid Refs:	Landranger:	SP 405 954	Eastings,Northings: 44057 29543
End Location:	Footpath U4, The Hollies		
End Grid Refs:	Landranger:	SP 405 954	Eastings,Northings: 44057 29547

Applicant's Name, Address & Postcode: John W. Dewis, Hinckley Ramblers			
Date Received:	13/07/2017	Date Determined:*	
Application Stage(s): <ul style="list-style-type: none"> • Application received 			

For Further Information			
Case Officer:	Not allocated		
Telephone:	0116 305 0001	Fax:	0116 305 6161
Email:	footpaths@leics.gov.uk		

Contents List:	Page:
Application Form	2
Map accompanying the application	3
Additional Documents	
Inspector's Decision	

* Note the **Determination Date** is the occasion on which Leicestershire County Council formally decided whether or not to make an order in response to this application.



Form PT634

APPLICATION FOR DEFINITIVE MAP MODIFICATION ORDER

**WILDLIFE AND COUNTRYSIDE ACT 1981
DEFINITIVE MAP AND STATEMENT FOR THE COUNTY OF LEICESTERSHIRE**

Please complete this form and return it together with Form PT636, and any evidence you wish to submit, to: Safe and Sustainable Travel Team, Environment and Transport Department, Leicestershire County Council, County Hall, Glenfield, Leicester, LE3 8RJ.

I/We JOHN W. DEWIS
of HINCKLEY RAMBLERS

hereby apply for an Order under Section 53(2) of the Wildlife and Countryside Act 1981, modifying the Definitive Map and Statement for the area by

- *adding a footpath/bridleway/byway open to all traffic
- ~~*deleting a footpath/bridleway/byway open to all traffic~~
- *upgrading the footpath/bridleway
- ~~*downgrading the bridleway/byway open to all traffic~~
- ~~*varying the particulars in the Definitive Statement relating to the footpath/bridleway/byway open to all traffic~~

(*delete as appropriate)

which runs from PUBLIC FOOTPATH U4
to HIGHAM LANE WYKIN Hinckley

as shown on the attached plan.

I/We attach copies of the following documentary evidence (including statements of witnesses) in support of this application:

List of Documents

.....

.....

.....

.....

.....

Signed  Dated 7th July 2017

How we use your information

Any information you provide will be used in accordance with the Data Protection Act 1998 and other relevant legislation. The information will be used to consider your application for a Definitive Map Modification Order. A copy of your application (including your name and address) will be published online in order to meet statutory requirements. Other personal details (such as telephone numbers, email addresses and signatures) will be removed before publication.

Leicestershire County Council - Alleged Public Footpath Connecting Public Footpath U4 to Higham Lane, Wykin, Hinckley

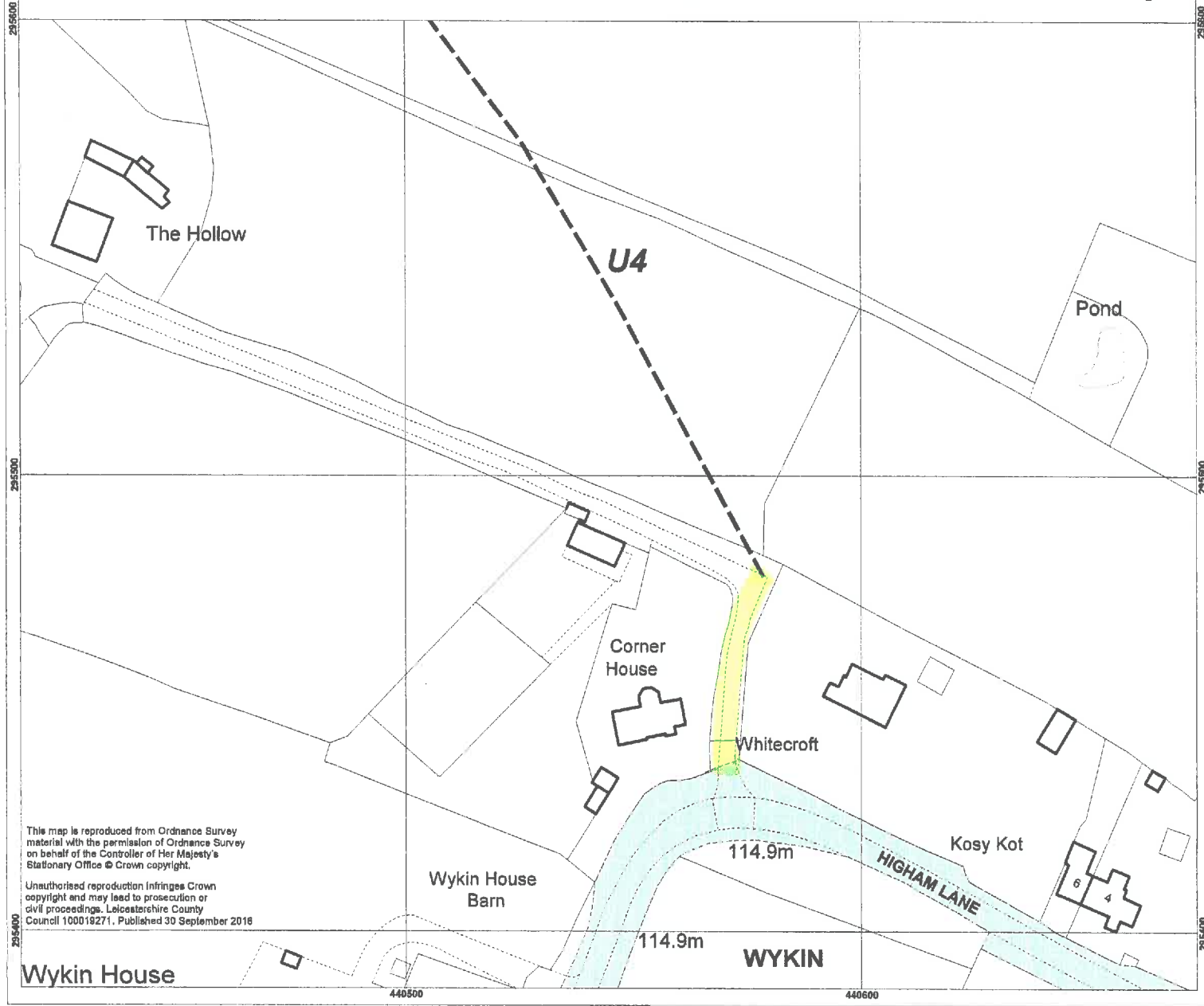

Location Plan

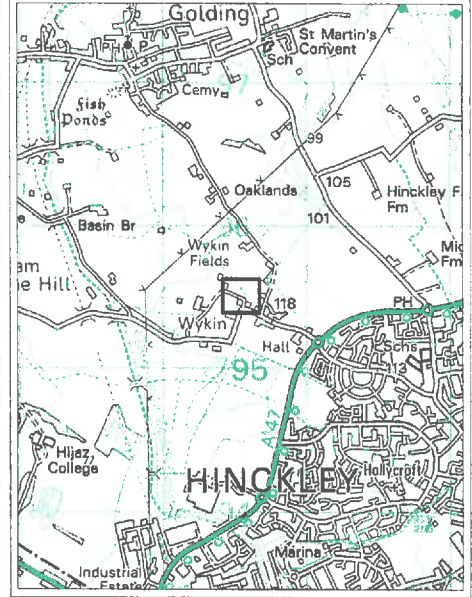

Key

- Existing public footpath
- Claimed public footpath

Environment & Transport Department,
County Hall, Glenfield,
Leicestershire LE3 8RJ
email footpaths@leics.gov.uk
Director Phil Crossland



App. Plan

Scale 1:1250

This map is reproduced from Ordnance Survey material with the permission of Ordnance Survey on behalf of the Controller of Her Majesty's Stationary Office © Crown copyright.

Unauthorised reproduction infringes Crown copyright and may lead to prosecution or civil proceedings. Leicestershire County Council 100019271. Published 30 September 2016