

# PROPOSED NEW JUNCTION LAYOUT

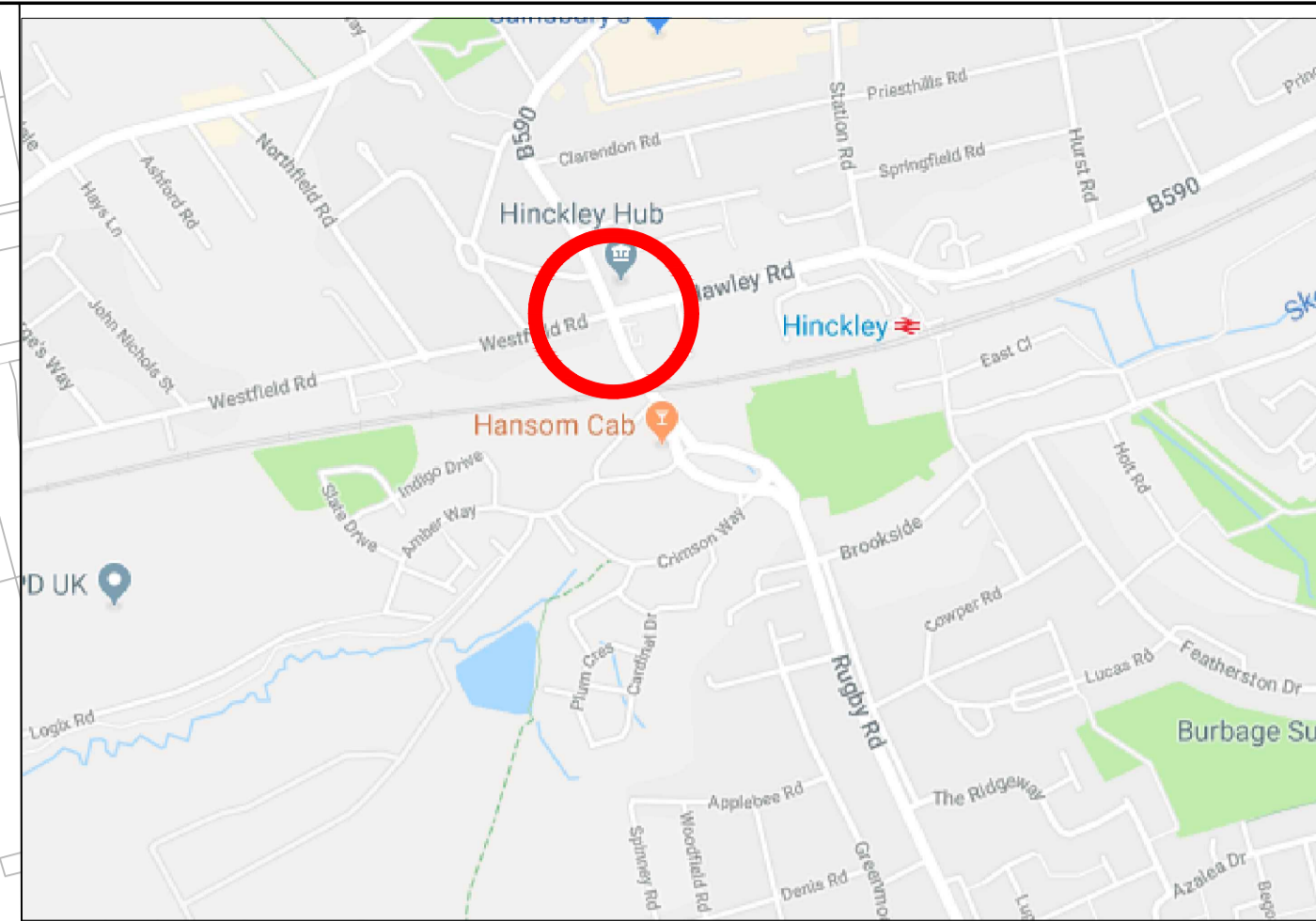

- KEY:-**
- FOOTWAY
  - CARRIAGEWAY
  - LANDSCAPED AREAS
  - PROPOSED TRAFFIC SIGNALS
  - PEDESTRIAN BARRIER
  - EXISTING TACTILE PAVING FOR CROSSING
  - PROPOSED TACTILE PAVING FOR CROSSING
  - EXISTING KERBS TO BE REMOVED

**LEFT TURN BAN FROM WESTFIELD ROAD**

**TREE TO BE REMOVED**

**ROAD WIDENING AND NEW RIGHT HAND TURN LANE**

**NEW PEDESTRIAN CONTROLLED CROSSING**

**NEW PEDESTRIAN CROSSING ISLAND**

**ROAD WIDENING AND NEW DEDICATED LEFT TURN**

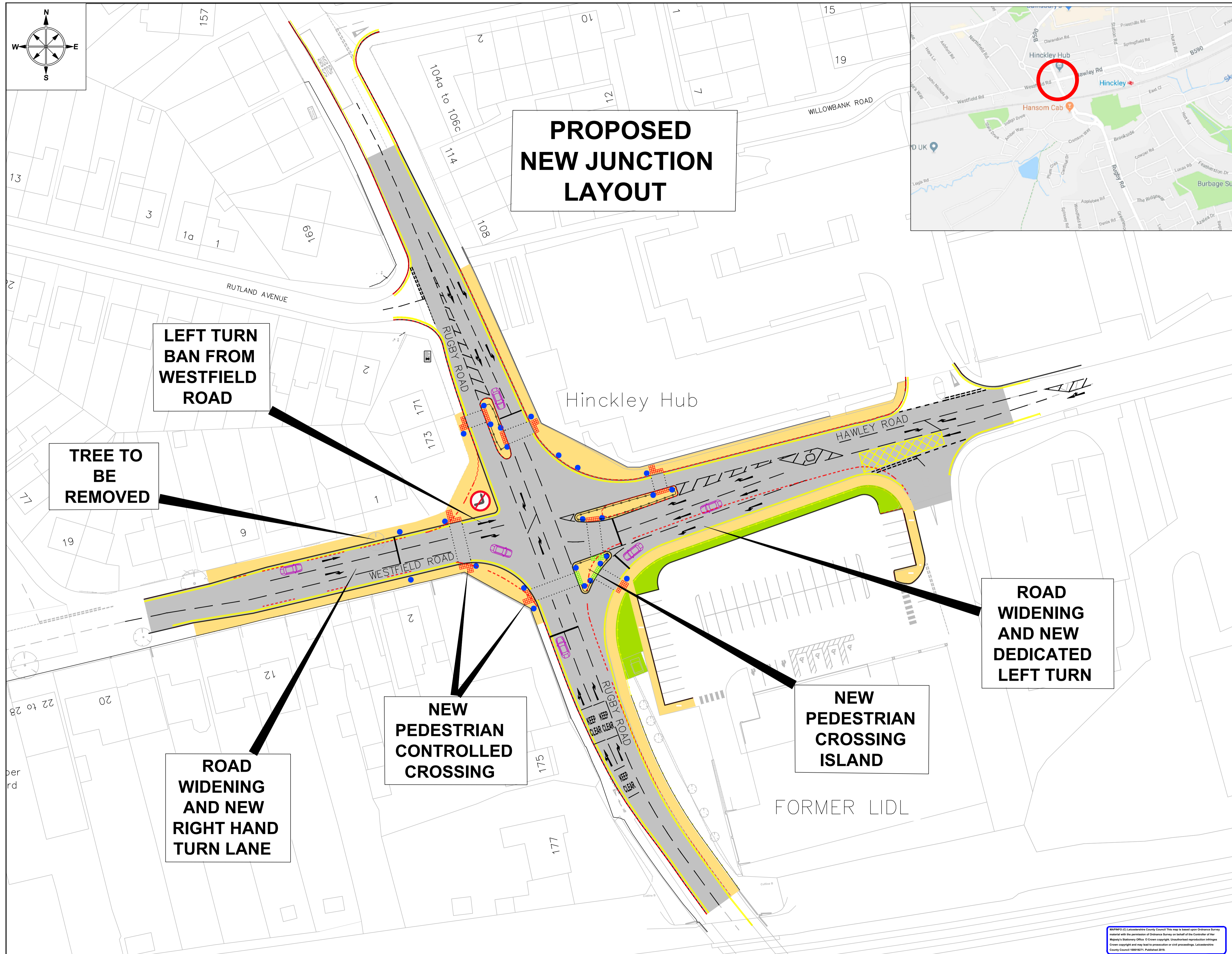

REVISION APPROVED	AMENDMENT	SIGNED/DATE	REV
ENVIRONMENT AND TRANSPORT DEPARTMENT			
ANN CARRUTHERS DIRECTOR			
<b>LEICESTERSHIRE HIGHWAYS</b>			
CLIENT: ASSET AND MAJOR PROGRAMMES			
TITLE: Hawley Road/Rugby Road Junction Improvements Hinckley			
CONSULTATION PLAN			
DRAWING NUMBER	SCALE		
HINCKLEY24-001-CONS01D	NTS		
PREPARED BY: L Walker	DATE: 10/06/2019		
CHECKED BY: D Colls	SIZE: A3		
APPROVED BY: J McGuinness	CORR. FILE:-		
AUTOCAD PROJECT DWF: <a href="#">HINCKLEY24-001-CONS01D.dwf</a>			
COUNTY HALL * GLENFIELD * LEICESTER * LE5 8RJ			
Tel No : 0116 3050001 Direct Dial : 0116 305xxxx			
E Mail address: <a href="mailto:leicester@leicestershire.gov.uk">leicester@leicestershire.gov.uk</a>			

MAPINFO © Leicestershire County Council This map is based upon Ordnance Survey material with the permission of Ordnance Survey on behalf of the Controller of Her Majesty's Stationery Office. © Crown copyright. Unauthorised reproduction infringes Crown copyright and may lead to prosecution or civil proceedings. Leicestershire County Council copyright. Published 2019.