

Form CA17

**Notice of landowner deposits under Section 31(6) of the Highways Act 1980
and Section 15A(1) of the Commons Act 2006**

LEICESTERSHIRE COUNTY COUNCIL

An application to deposit a map and statement under Section 31(6) of the Highways Act 1980 and deposit a statement under Section 15A(1) of the Commons Act 2006 has been made in relation to the land described below and shown outlined in red on the accompanying map.

PLEASE NOTE:

This deposit may affect rights over the land described below. Deposits made under Section 31(6) of the Highways Act 1980 may prevent deemed dedication of public rights of way over such land under Section 31(1) of that Act.

Deposits made under Section 15A(1) of the Commons Act 2006 may affect the ability to register such land as a town or village green under Section 15 of that Act. Please see guidance at

<http://www.defra.gov.uk/rural/protected/greens/> for further information.

Description of land(s) (including full address and postcode):

Land at Great Glen, Leicestershire LE8 9FL

Name of Parish, Ward of District in which the land(s) is situated:

In the Parish of Great Glen in the District of Harborough

The deposit was submitted by Mather Jamie, 3 Bank Court, Weldon Road, Loughborough LE11 5RF on behalf of Parkers of Leicester Ltd Investments Limited on 19th November 2019

The Authority maintains a register of maps, statements and declarations deposited under Section 31A of the Highways Act 1980 and Section 15A of the Commons Act 2006.

Work on the development of an electronic version of the register is ongoing. Further information about Section 31(6) and Section 15A can be accessed online at

<https://www.leicestershire.gov.uk/environment-and-planning/planning/commons-and-village-greens>

<https://www.leicestershire.gov.uk/environment-and-planning/planning/highway-statements-and-declarations>

The register can be inspected by appointment with Jane Moore (free of charge) at the address below between the hours of 10.00 a.m. and 3.00 p.m. Monday to Friday.

jane.x.moore@leics.gov.uk

Legal Services

Leicestershire County Council

County Hall

Glenfield

Leicester

LE3 8RA

Signed on behalf of Leicestershire County Council:

Name and position of Signatory: Lauren Haslam, Director of Law and Governance

Date: 6th February 2020

Extract From The Definitive Map of Public Rights of Way for Leicestershire Land between the A6 and London Road (Old A6) at Great Glen

Environment & Transport Department,
County Hall, Glenfield,
Leicestershire LE3 8RJ
email footpaths@leics.gov.uk
Director Ann Carruthers



Compiled on 6 November 2019 Scale 1:2500

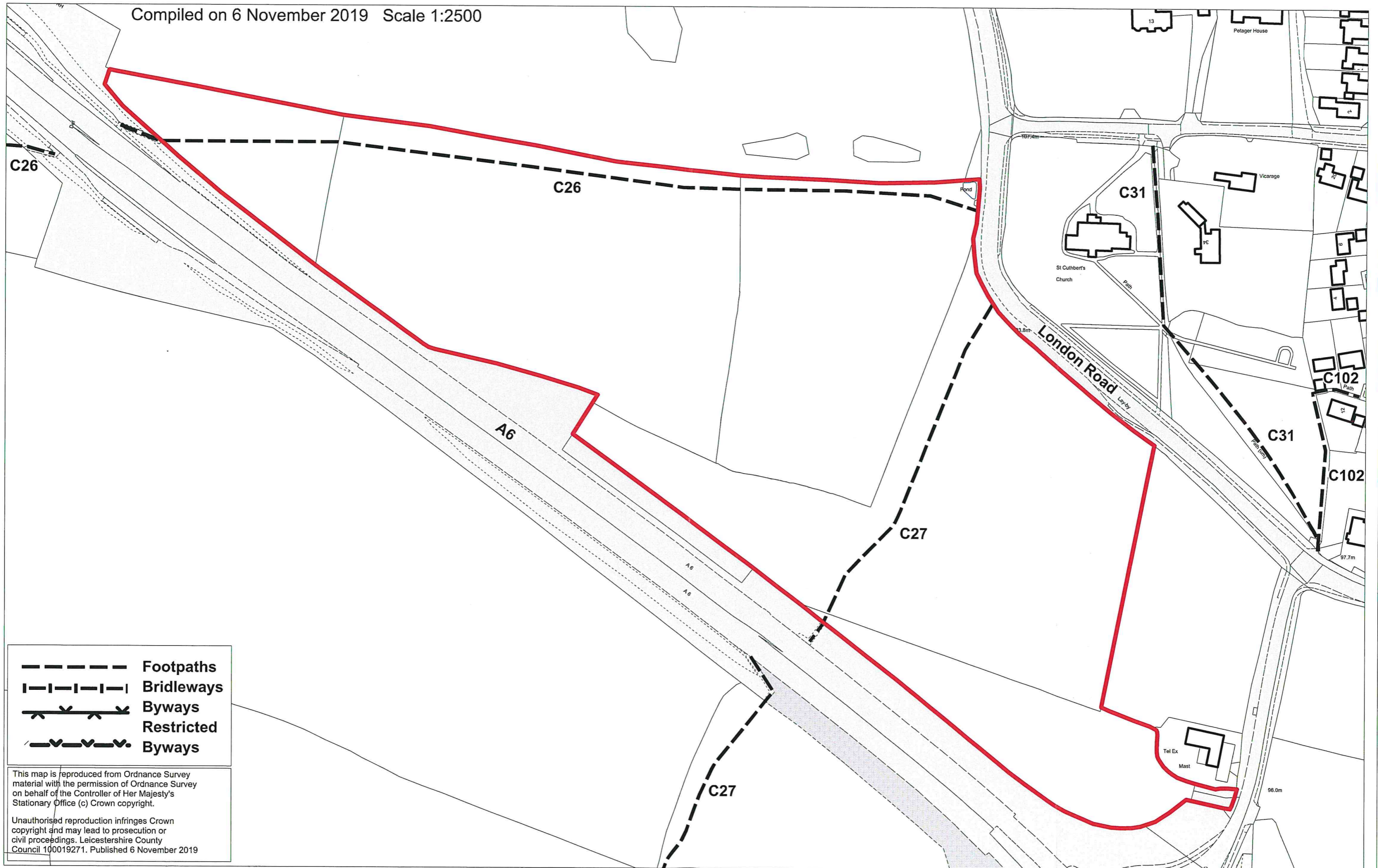

- Footpaths
- |-|-|-| Bridleways
- >---> Byways
- >---> Restricted
- >---> Byways

This map is reproduced from Ordnance Survey material with the permission of Ordnance Survey on behalf of the Controller of Her Majesty's Stationary Office (c) Crown copyright.

Unauthorised reproduction infringes Crown copyright and may lead to prosecution or civil proceedings. Leicestershire County Council 100019271. Published 6 November 2019