

PROJECT
A606 NORTH AND EAST MELTON MOWBRAY DISTRIBUTOR ROAD

CLIENT
LEICESTERSHIRE COUNTY COUNCIL (LCC)
County Hall, Glenfield
Leicester, LE3 8RA
tel: +44 (0)116 232 3232
www.leicestershire.gov.uk

CONSULTANT
AECOM
12 Regan Way,
Chetwynd Business Park
Chilwell, Nottingham, NG9 6RZ
tel: +44 (0)115 907 7000
www.aecom.com

- NOTES**
1. ALL DIMENSIONS ARE IN METRES UNLESS STATED OTHERWISE.
 2. THIS DRAWING IS BASED ON ORDNANCE SURVEY DATA.
 3. FURTHER DETAILS FOR EACH PLOT ARE IN THE STATEMENT OF REASONS AND SCHEDULE OF REFERENCE.
 4. PLANS FOR INDIVIDUAL PLOTS ARE AVAILABLE AT HIGHER SCALES, SEE DRAWINGS 60542201-LCC-LSI-GEN_LO_ZZ_Z-DR-ZL-(0056 TO 0069).

KEY

	PLOT ACQUIRED FOR PERMANENT TITLE
	NEW RIGHTS AND INTERESTS TO BE ACQUIRED

MINOR REVISION	DB	AJ	05/06/20	C01
FINAL CHECK AND APPROVE ISSUE	VH	AJ	17/06/20	A1

PROJECT MANAGEMENT INITIALS
DESIGNED: DB CHECKED: AJ APPROVED: IV

INTERNAL PROJECT NUMBER **SCALE**
60542201 1:2500

STATUS **BS1192 SUITABILITY**
APPROVED STAGE 1 A1

SHEET TITLE
MAPS REFERRED TO IN THE LEICESTERSHIRE COUNTY COUNCIL (A606 NORTH & EAST MELTON MOWBRAY DISTRIBUTOR ROAD) COMPULSORY PURCHASE ORDER 2020.

PLAN 4 OF 7
DRAWING NUMBER **REV**
60542201-LCC-LSI-S3_GEN_ZZ_Z-DR-ZL-0004 P01

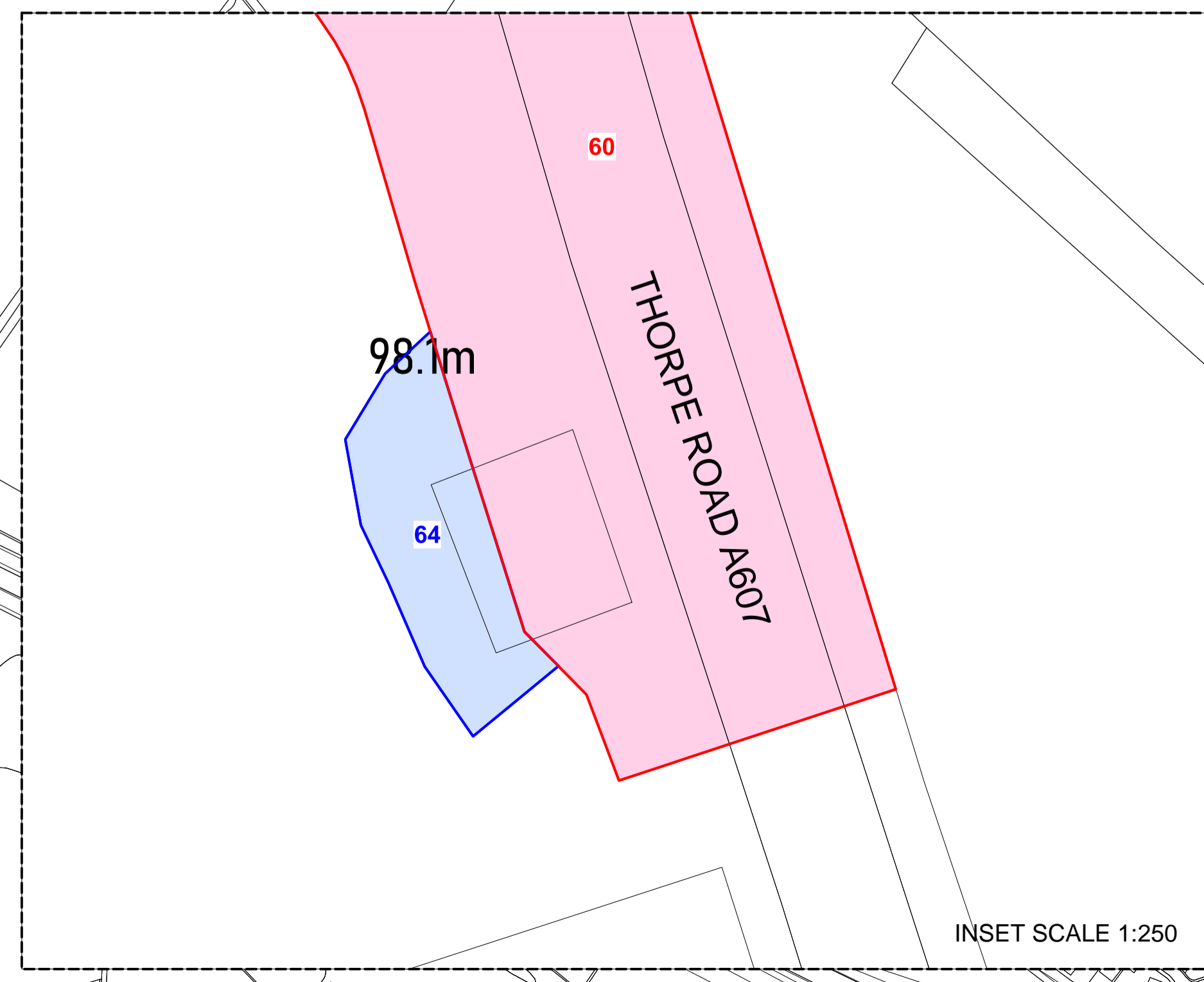
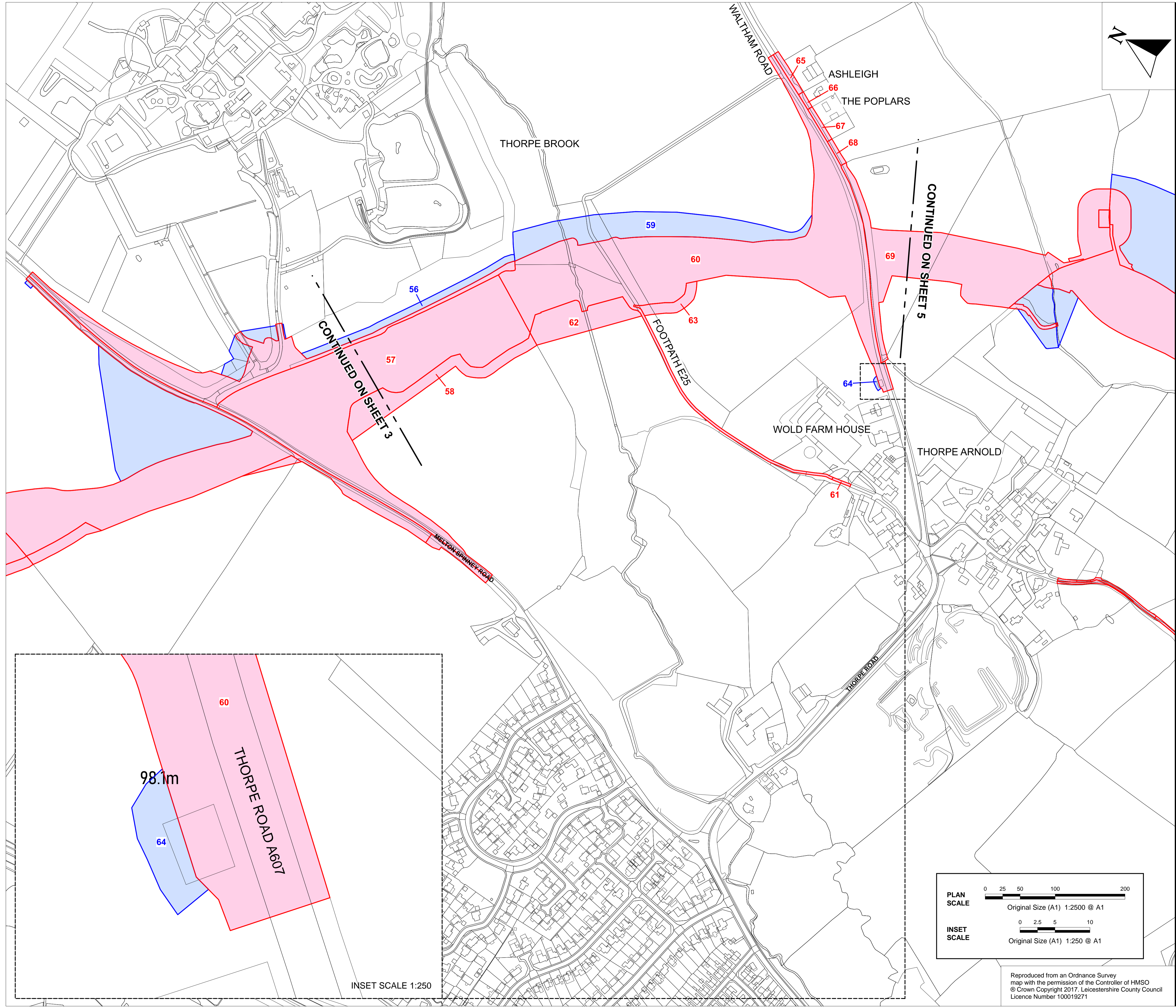

INSET SCALE 1:250

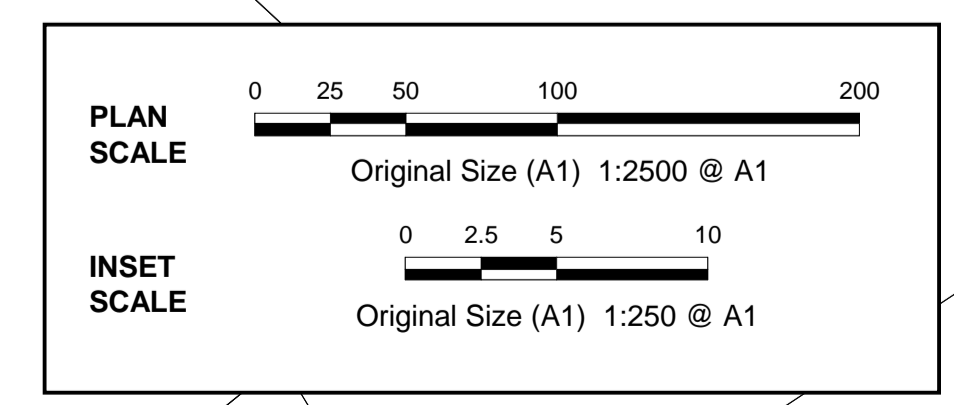

Reproduced from an Ordnance Survey map with the permission of the Controller of HMSO © Crown Copyright 2017, Leicestershire County Council Licence Number 100019271

This drawing has been prepared for the use of AECOM's client (LCC). It may not be used, modified, reproduced or relied upon by third parties, except as agreed by law. AECOM accepts no responsibility, and denies any liability whatsoever, to any party that uses or relies on this drawing without AECOM's express written consent. Do not scale this document. All measurements must be obtained from the stated dimensions.