

Form CA17

**Notice of landowner deposits under Section 31(6) of the Highways Act 1980  
and Section 15A (1) of the Commons Act 2006**

**LEICESTERSHIRE COUNTY COUNCIL**

An application to deposit a map and statement under Section 31(6) of the Highways Act 1980 and deposit a statement under Section 15A(1) of the Commons Act 2006 has been made in relation to the land described below and shown outlined in red on the accompanying map.

**PLEASE NOTE:**

**This deposit may affect rights over the land described below. Deposits made under Section 31(6) of the Highways Act 1980 may prevent deemed dedication of public rights of way over such land under Section 31(1) of that Act.**

**Deposits made under Section 15A(1) of the Commons Act 2006 may affect the ability to register such land as a town or village green under Section 15 of that Act. Please see guidance at**

**<http://www.defra.gov.uk/rural/protected/greens/> for further information.**

Description of land(s) (including full address and postcode):

Land at Stoneygate Rugby Club, Scraptoft, Leicestershire LE7 9SQ

Name of Parish, Ward of District in which the land(s) is situated:  
In the Parish of Scraptoft in the District of Harborough

The deposit was submitted by Mather Jamie Limited, 3 Bank Court, Weldon Road, Loughborough, Leics. LE11 5EF on behalf of Parkers of Leicester Ltd. on 4<sup>th</sup> March 2020.

The Authority maintains a register of maps, statements and declarations deposited under Section 31A of the Highways Act 1980 and Section 15A of the Commons Act 2006.

Work on the development of an electronic version of the register is ongoing. Further information about Section 31(6) and Section 15A can be accessed online at

<https://www.leicestershire.gov.uk/environment-and-planning/planning/commons-and-village-greens>

<https://www.leicestershire.gov.uk/environment-and-planning/planning/highway-statements-and-declarations>

The register can be inspected by appointment with Jane Moore (free of charge) at the address below between the hours of 10.00 a.m. and 3.00 p.m. Monday to Friday.

[jane.x.moore@leics.gov.uk](mailto:jane.x.moore@leics.gov.uk)

Legal Services

Leicestershire County Council

County Hall

Glenfield

Leicester

LE3 8RA

Signed on behalf of Leicestershire County Council:

Name and position of Signatory: Lauren Haslam, Director of Law and Governance

Date: 15<sup>th</sup> June 2021



# Leicestershire County Council - Statutory Deposit and Declaration. Land at Stoneygate Rugby Club, Scraptoft. Extract from the Definitive Map, Public Footpath D26a

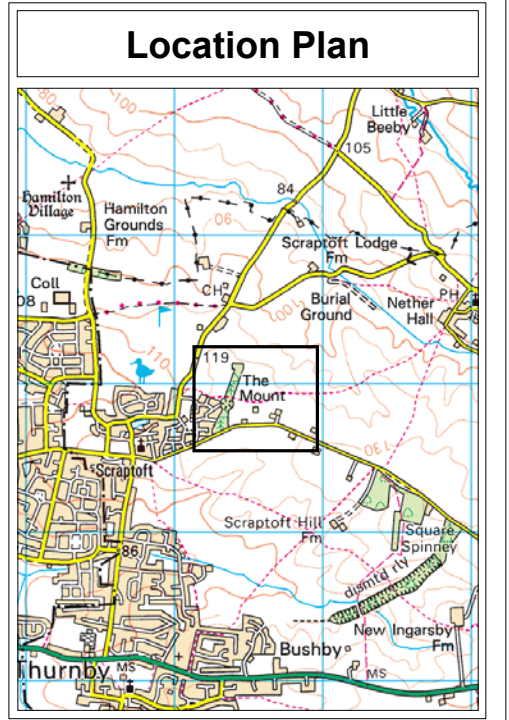
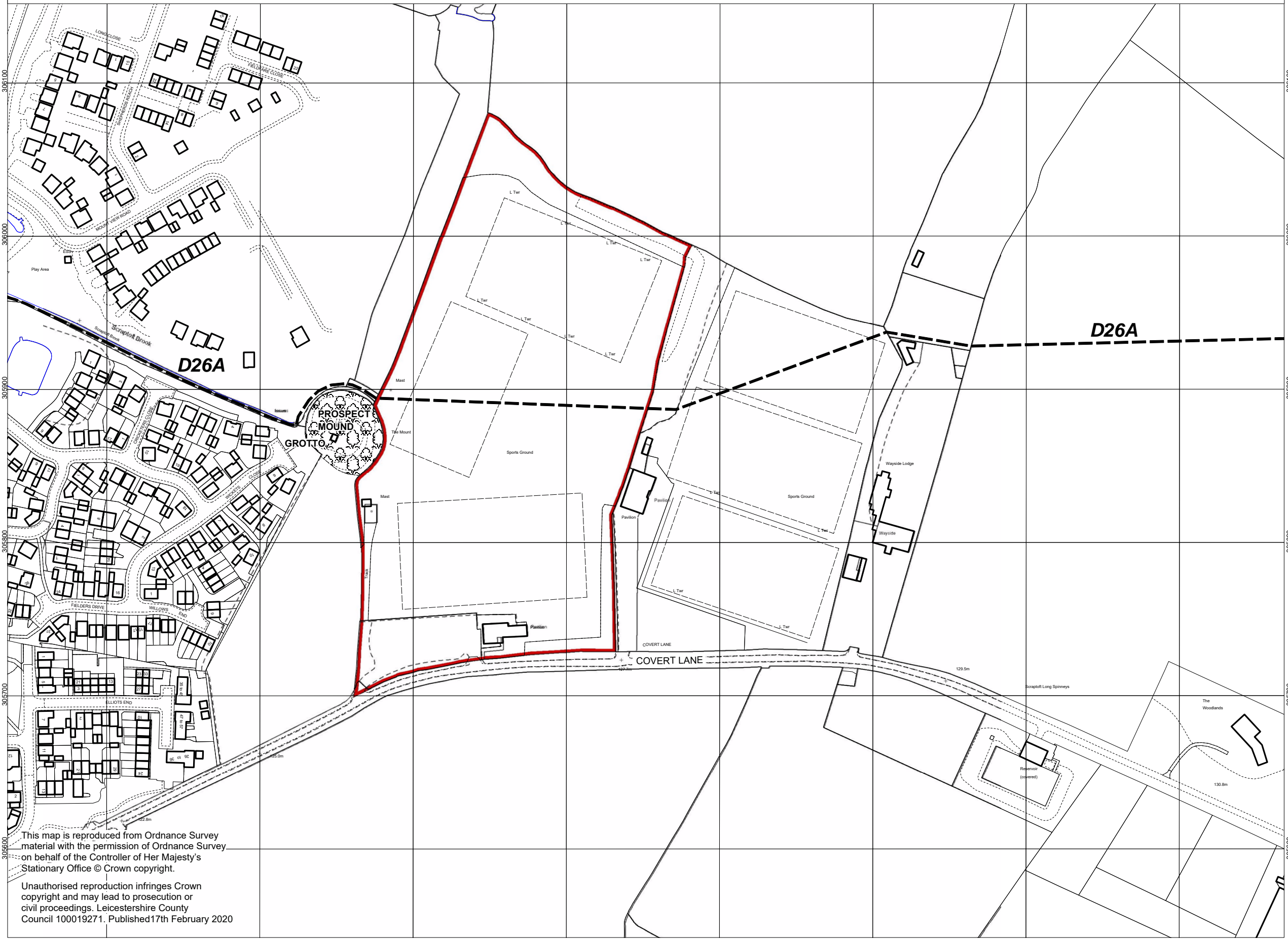

- Key**
- Public footpaths
  - Public Bridleways
  - Byways Open to All Traffic
  - Restricted Byways

Environment & Transport Department,  
County Hall, Glenfield,  
Leicestershire LE3 8RJ  
email [footpaths@leics.gov.uk](mailto:footpaths@leics.gov.uk)  
Ann Carruthers, Director



**Plan No SD26a**  
Scale 1:2500 (when printed at A3)

This map is reproduced from Ordnance Survey material with the permission of Ordnance Survey on behalf of the Controller of Her Majesty's Stationary Office © Crown copyright.  
Unauthorised reproduction infringes Crown copyright and may lead to prosecution or civil proceedings. Leicestershire County Council 100019271. Published 17th February 2020