

Form CA17

Notice of landowner deposits under Section 31(6) of the Highways Act 1980 and Section 15A(1) of the Commons Act 2006

LEICESTERSHIRE COUNTY COUNCIL

An application to deposit a map and statement under Section 31(6) of the Highways Act 1980 and deposit a statement under Section 15A(1) of the Commons Act 2006 has been made in relation to the land described below and shown outlined in red on the accompanying map.

PLEASE NOTE:

This deposit may affect rights over the land described below. Deposits made under Section 31(6) of the Highways Act 1980 may prevent deemed dedication of public rights of way over such land under Section 31(1) of that Act.

Deposits made under Section 15A(1) of the Commons Act 2006 may affect the ability to register such land as a town or village green under Section 15 of that Act. Please see guidance at

<http://www.defra.gov.uk/rural/protected/greens/> for further information.

Description of land(s) (including full address and postcode):

Land at Hoton Road, Wymeswold, LE12 6UA

Name of Parish, Ward of District in which the land(s) is situated:

In the Parish of Wymeswold in the Borough of Charnwood

The deposit was submitted by Fisher German LLP, The Estates Office, Ashby-de-la-Zouch LE65 2UZ on behalf of World Habitat in their capacity as duly Authorised Agents received by this Authority on 16th November 2021.

The Authority maintains a register of maps, statements and declarations deposited under Section 31A of the Highways Act 1980 and Section 15A of the Commons Act 2006.

Work on the development of an electronic version of the register is ongoing. Further information about Section 31(6) and Section 15A can be accessed online at

<https://www.leicestershire.gov.uk/environment-and-planning/planning/highway-statements-and-declarations>

The register can be inspected by appointment with Jane Moore (free of charge) at the address below between the hours of 10.00 a.m. and 3.00 p.m. Monday to Friday.

jane.x.moore@leics.gov.uk

Legal Services
Leicestershire County Council
County Hall
Glenfield
Leicester
LE3 8RA

Signed on behalf of Leicestershire County Council:



Name and position of Signatory: Lauren Haslam, Director of Law and Governance

Date: 19th April 2022

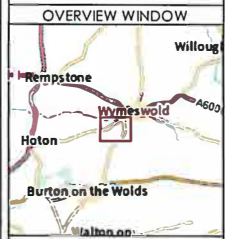
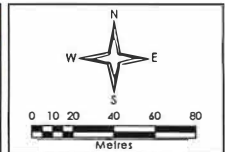
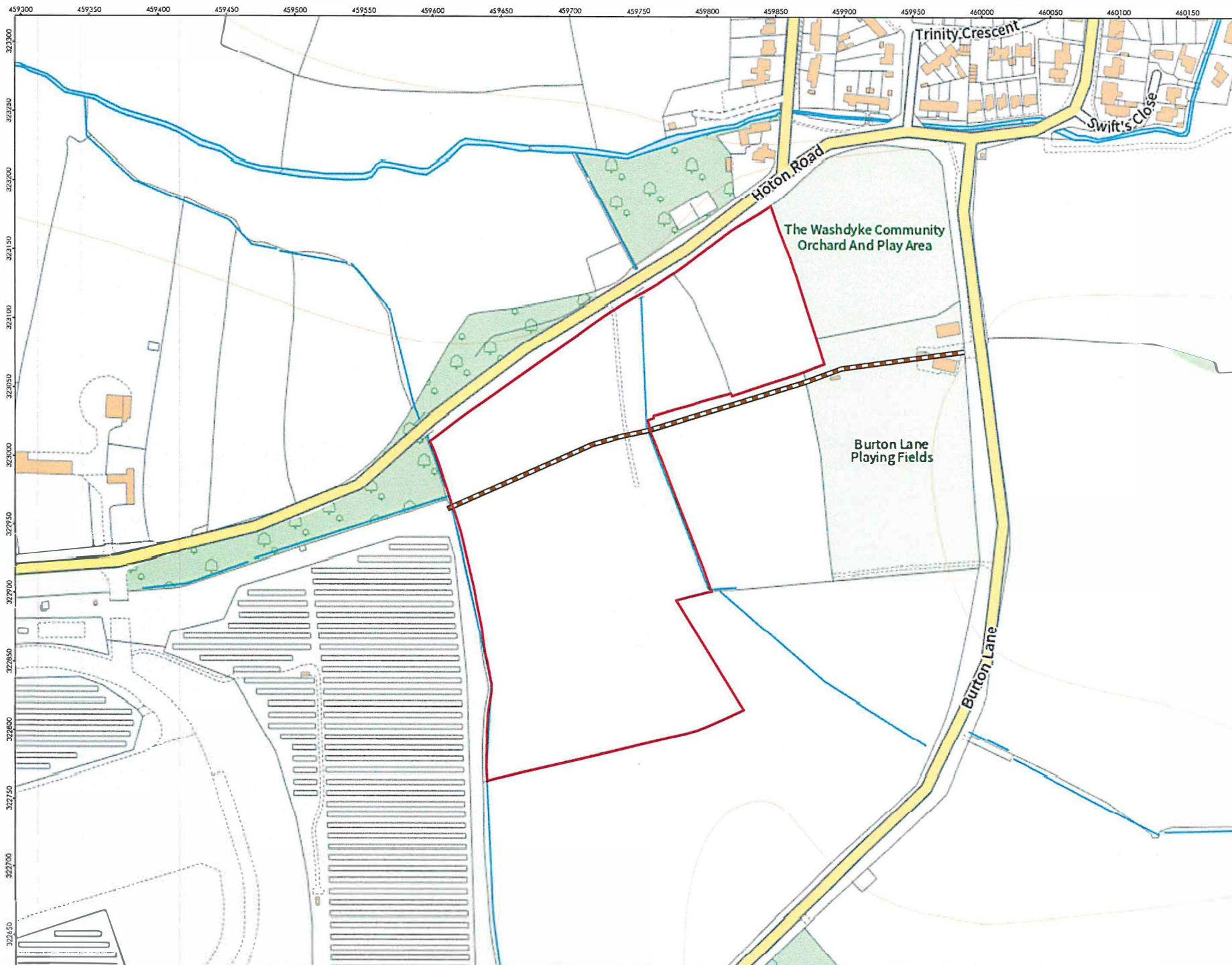

- LEGEND:
- Land of interest = 14.65 ac
 - Footpath

REVISION: A

CLIENT:
World Habitat

SCHEME: SITE PLAN
Section 31(6) Notice

TITLE: LT361275
PRoW's

FP: 109367

SCALE: 1:2,500 @ A3

DATE: 16/11/2021

© Crown copyright and database right 2021
Ordnance Survey License Number A110090337



THIS DRAWING IS PROTECTED BY COPYRIGHT. IT MAY NOT BE REPRODUCED IN ANY FORM OR BY ANY MEANS FOR ANY PURPOSE WITHOUT THE WRITTEN PERMISSION OF FISHER GERMAN LLP CHARTERED SURVEYORS



The Estates Office, Norman Court
Ashby de la Zouch,
Leicestershire, LE65 2UZ

01530 412821
<http://www.fishergerman.co.uk>
ashby@fishergerman.co.uk

DRAWING REF:
WHABITAT-2021-11-NI-SP-Section
31(6) Notice - LT361275 - PRoW