

**All Statutory Undertakers
with apparatus in Leicestershire**

Date: 24th August 2022
My Ref: CW22-006
Contact: Selim Ahmed
Phone: 0116 305 0001
Email: highwayscustomerservices@leics.gov.uk

LEICESTERSHIRE COUNTY COUNCIL

NEW ROADS AND STREET WORKS ACT 1991

DEPARTMENT OF ENVIRONMENT & TRANSPORT

NOTICE TO UNDERTAKERS – SECTION 58

THIS IS A NOTICE, NOT A SEARCH

The LEICESTERSHIRE COUNTY COUNCIL by its Director of Environment and Transport, acting in virtue of the powers vested in the Council as Highway Authority, hereby gives 3 months advance notice under Section 58 of the Act of its intention to execute substantial road works in accordance with the accompanying plan(s).

Subject to the exemptions in the Act and Regulations under it, no street works may be executed for a period of 36 months from the completion of the works described without the consent of the said Leicestershire County Council. Should such street works be planned you are requested to contact the above-named officer to discuss how the works can best be co-ordinated.

1. Scheme Title: Belton Road, Loughborough
2. Description of works: Carriageway resurfacing/strengthening and associated highway works
3. Highway and route number: Belton Road, Loughborough – refer to table below
4. USRN(s): 24900493 – refer to table below
5. Grid Reference: Belton Road, Loughborough – refer to table below
6. Terminal points of site: Belton Road, Loughborough – refer to table below (Refer to enclosed plan for location and extents of works)
7. Programmed start date: 27th February 2023
8. Programmed completion date: 4th March 2023
9. Address for reference: Belton Road, Loughborough – LE11

Yours faithfully,

Selim Ahmed
Engineer (Highways Delivery)

Environment and Transport Department
Leicestershire County Council, County Hall, Glenfield. Leicestershire LE3 8RJ
Telephone: 0116 305 0001
Email: highwayscustomerservices@leics.gov.uk

Director, Ann Carruthers

www.leicestershire.gov.uk

No.	Permit ref	Road Name /URSN	Route number.	Parish	Grid reference	Terminal points of site
1	518192	Belton Road, Loughborough (6500152)	N/A	Loughborough	4452906, 320247	453120, 320454

Environment and Transport Department
 Leicestershire County Council, County Hall, Glenfield. Leicestershire LE3 8RJ
 Telephone: 0116 305 0001
 Email: highwayscustomerservices@leics.gov.uk

Director, Ann Carruthers

www.leicestershire.gov.uk

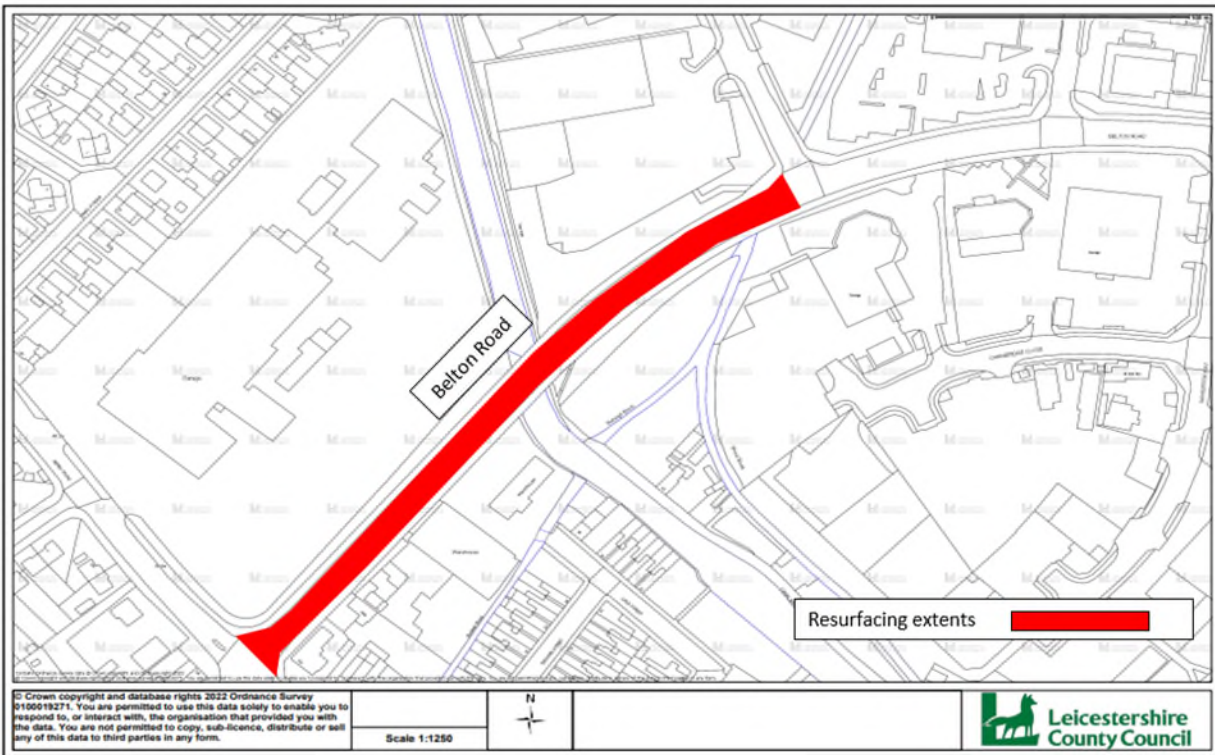
S58 Belton Road, Loughborough

Environment and Transport Department
Leicestershire County Council, County Hall, Glenfield. Leicestershire LE3 8RJ
Telephone: 0116 305 0001
Email: highwayscustomerservices@leics.gov.uk

Director, Ann Carruthers

www.leicestershire.gov.uk